

# Dundalk Co. Louth

Town centre health check and  
urban design

MARCH 16, 2017 | DUBLIN CASTLE CONFERENCE CENTRE

# Introduction

## SYNOPSIS

A presentation to outline the work of Queen's University Belfast students carried out within Dundalk, Co. Louth. The project combines a Town Centre Health Check (TCHC) study along with Urban Design analysis and proposals.



# Acknowledgements

## CONTRIBUTERS

- Alison Harvey (Heritage Council)
- Brendan McSherry (Louth CoCo)
- Dundalk BIDS Team
- Peter Hutchinson (Irish Landscape Inst.)
- James Hennessy, Aiofe McGee & Tadhg Daly



# Study Context

## AREA OVERVIEW

- Second largest town in Ireland
- Largest town in Louth, but smaller than Drogheda
- Urban morphology & edge of centre retail outlets
- Marshes, Long Walk shopping centre and now vacant Carroll's Village Centre

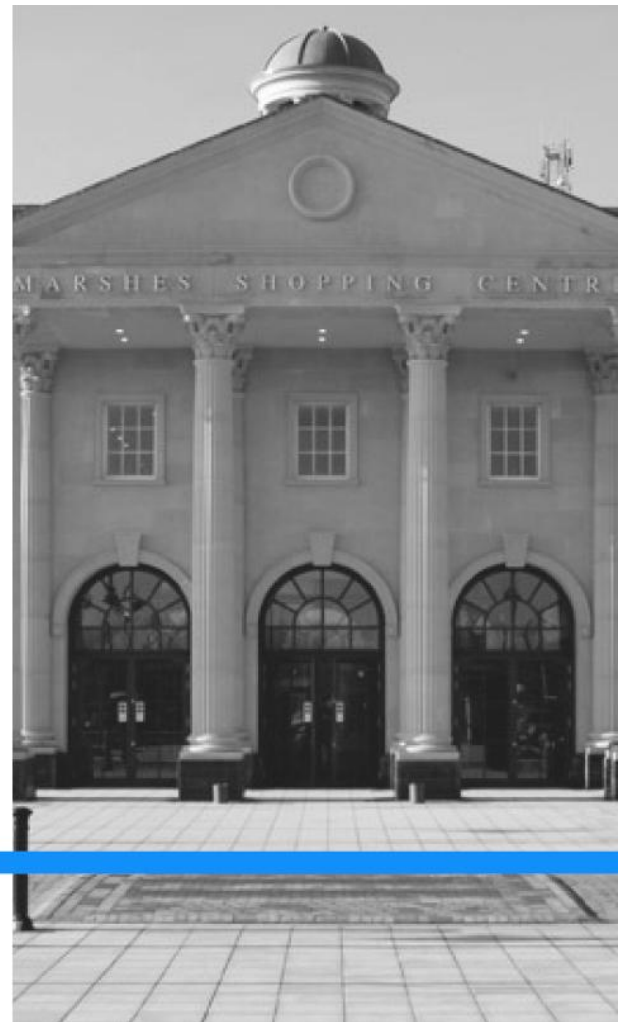





A detailed street map of Carroll's Village and surrounding areas. The map shows a grid of streets, green spaces like St. Helena Park and Sports Ground, and a large body of water to the east. Three specific areas are highlighted with solid blue shapes, indicating retail outlets. The text 'CARROLL'S VILLAGE (VACANT)' is overlaid on the map, with '(VACANT)' in red. Other labels on the map include 'LONG WALK CENTRE', 'MARSHES CENTRE', and 'MILITARY BARRACKS'.

**CARROLL'S VILLAGE (VACANT)**

**LONG WALK CENTRE**

**MARSHES CENTRE**

**€ RETAIL OUTLETS**

# Carroll's Village

## VACANT RETAIL OUTLET

A vacant 2,984 SqM retail unit. Located within Carroll Village Shopping Centre, off the Long Walk and adjacent to the retail thoroughfares of Clanbrassil Street and Earl Street in the heart of Dundalk town.



# Student Brief

## CORE ELEMENTS

- Pilot project with MSc Urban Design module.
- Analysis | Strategies | Individual design proposals.
- TCHC for Dundalk town centre.
- Survey work.
- 2 day overnight trip.





# Study Area

## LOCATION & CONTEXT

Primarily shaped by agreed parameters provided by Louth County Council in order to assist with the TCHC. The study had particular focus on Dundalk town centre with additional site specific locations.





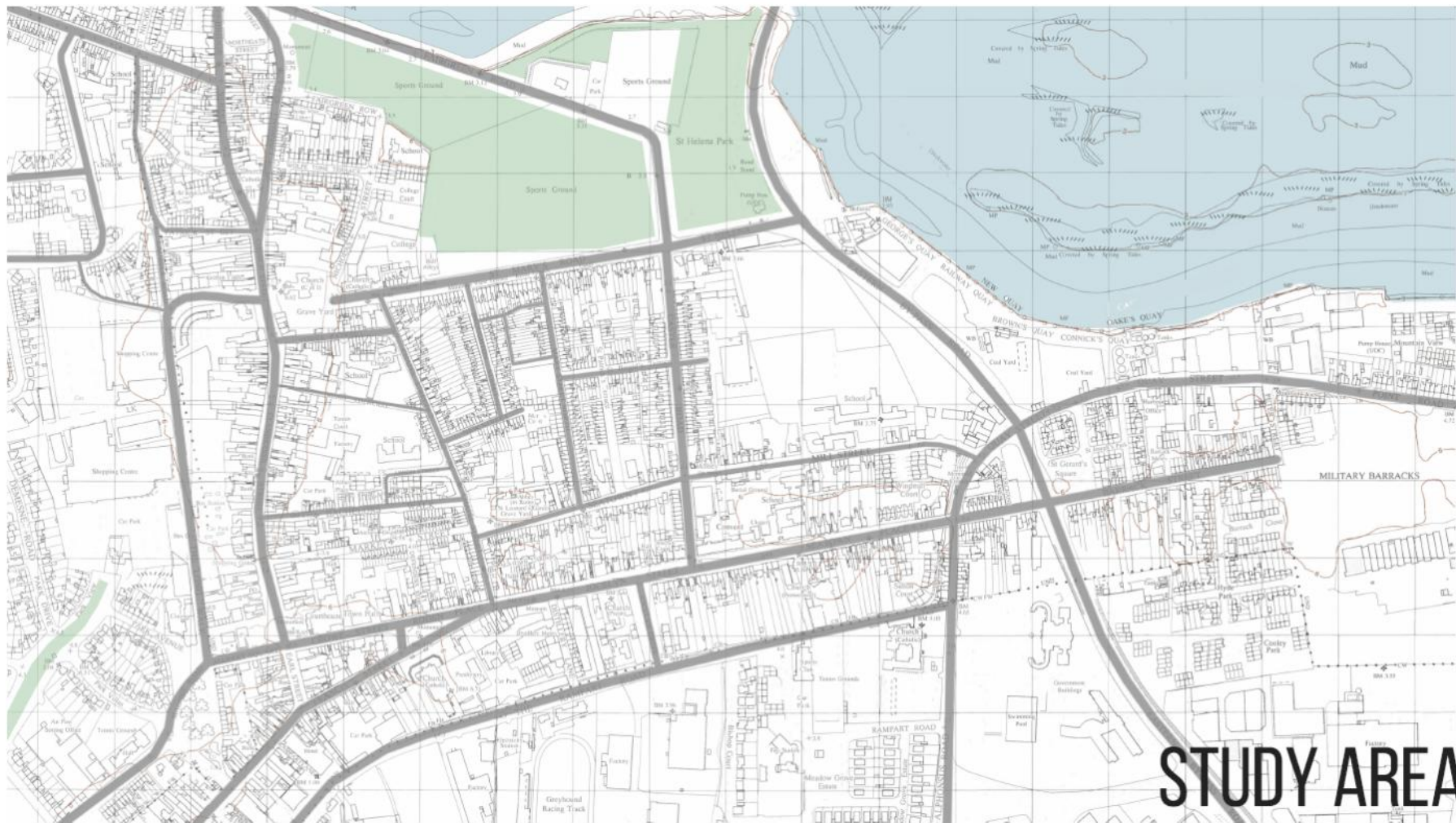

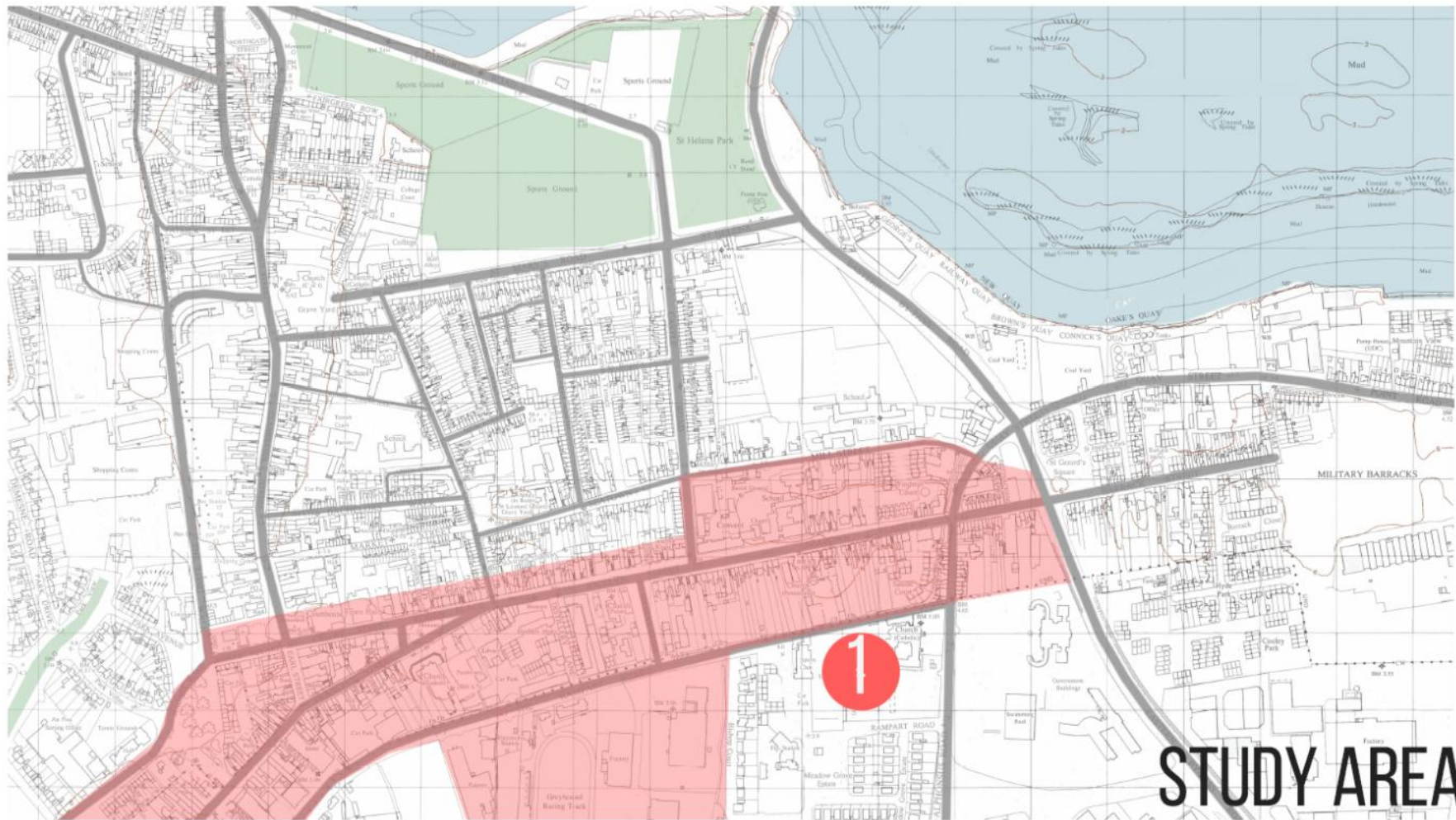



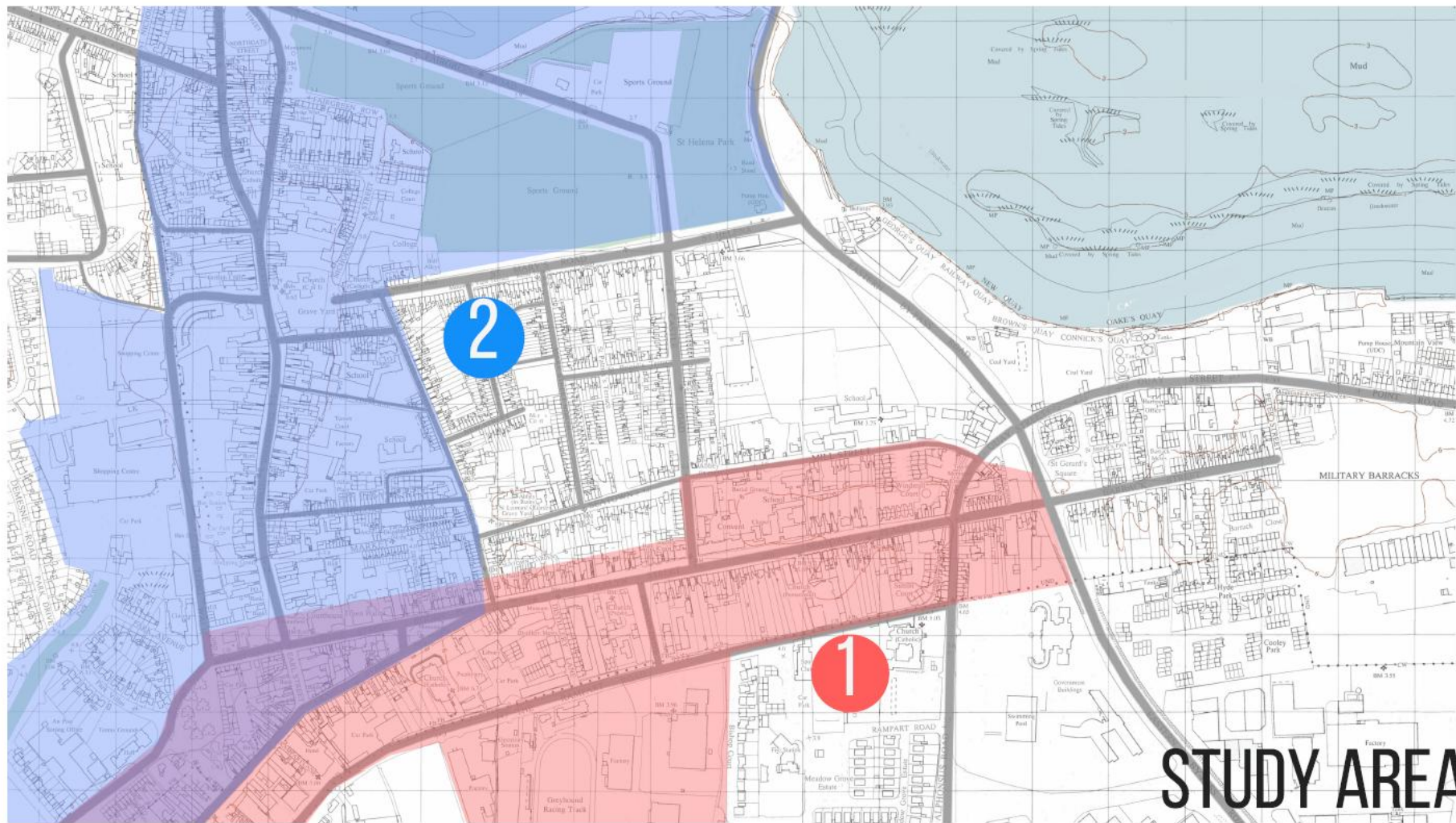

# STUDY AREA

A historical map of a coastal area, likely in the 19th century. The map is divided into three main colored regions: a blue-shaded area on the left labeled 'ST. NICHOLAS', a purple-shaded area in the center labeled 'DEARYS', and a red-shaded area on the right labeled 'MARSHES'. Three red circles are drawn on the map: one in the blue area, one in the purple area, and one in the red area. The map shows various streets, buildings, and landmarks. Key features include 'St Helena Park' and 'Sports Ground' in the blue area; 'Grave Yard', 'School', and 'Town Hall' in the purple area; and 'MILITARY BARRACKS', 'RAMPART ROAD', and 'Meadow Grove Estate' in the red area. The right side of the map shows a body of water with 'Mud' areas and 'Covered to Spring Tides' markings. The text 'ST. NICHOLAS' is in large white letters at the top left, 'DEARYS' is in large white letters in the center left, and 'MARSHES' is in large white letters at the bottom left. The text 'STUDY AREA' is in large black letters at the bottom right.

ST. NICHOLAS

DEARYS

MARSHES

STUDY AREA



# KEY SITES



ST.NICHOLAS



MARSHES



DEARYS



**Matthew Harvey**

---

MSc Urban Design

**Cultures & climates differ all over  
the world, but people are the same.  
They'll gather in public if you give  
them a good place to do it**

JAN GEHL - ARCHITECT

---

# TCHC and Diagnosis

DUNDALK, CO. LOUTH

An overview of the results and key findings of the Town Centre Health Check (TCHC), followed by a town centre diagnosis.





## CORE ELEMENTS OF TCHC



FOOTFALL



LAND USE



PUBLIC REALM

# FOOTFALL



TOWN CENTRE HEALTH CHECK

---

DUNDALK, CO. LOUTH





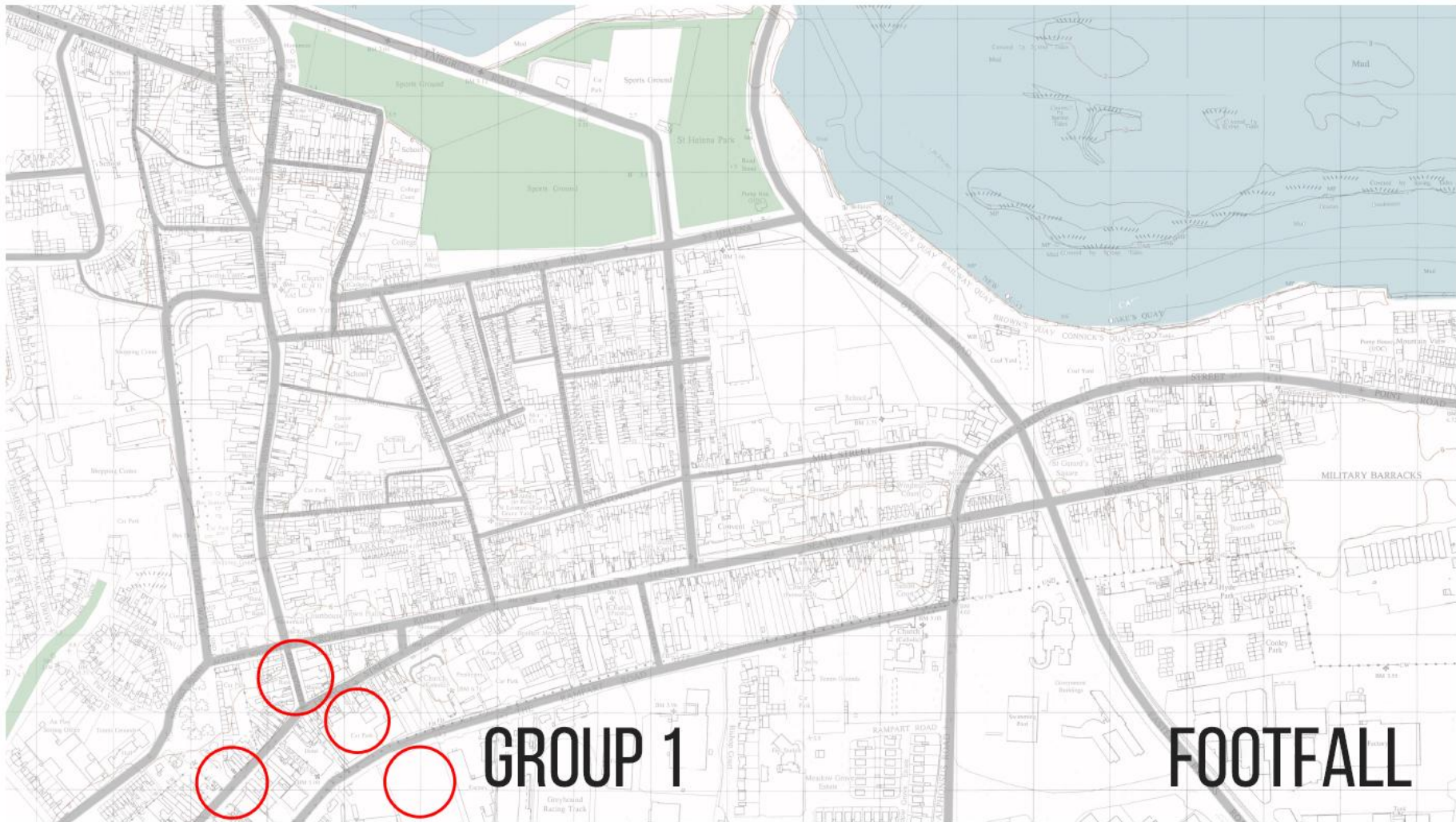







A detailed map of an urban area, likely a coastal town, showing streets, buildings, and green spaces. The map is overlaid with a grid. Several locations are marked with circles: three blue circles along a vertical road on the left, and four red circles along a diagonal road at the bottom. The text 'GROUP 2' is centered over the blue circles, and 'GROUP 1' is centered over the red circles. The text 'FOOTFALL' is in the bottom right corner. The map includes labels for various landmarks such as 'St Helena Park', 'Sports Ground', 'MILITARY BARRACKS', and 'RAMPART ROAD'. The coastline is visible on the right side, with labels for 'Mud' and 'Quay'.

**GROUP 2**

**GROUP 1**

**FOOTFALL**







**FRIDAY** Greyhound  
Racing Track



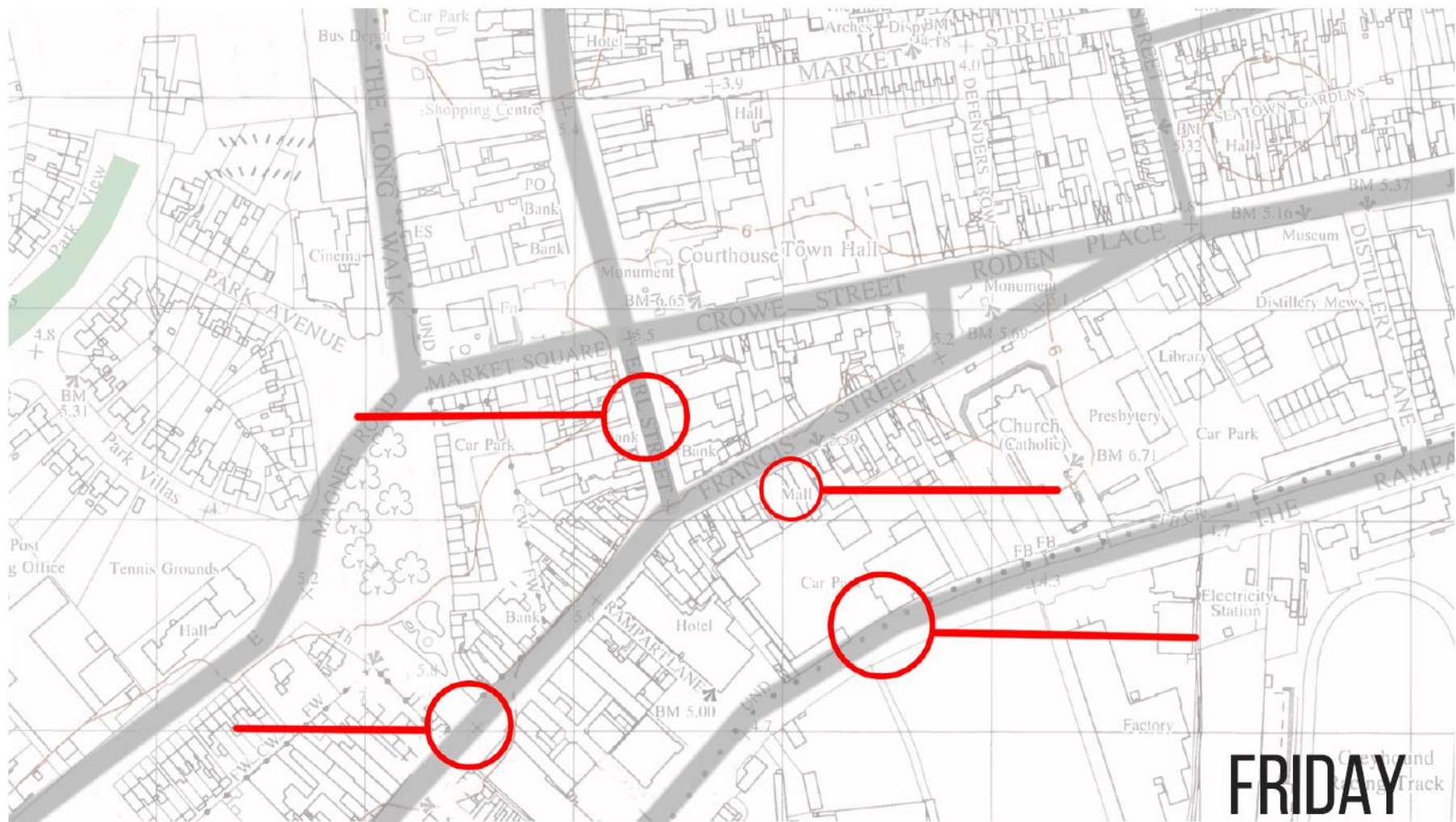

**FRIDAY**

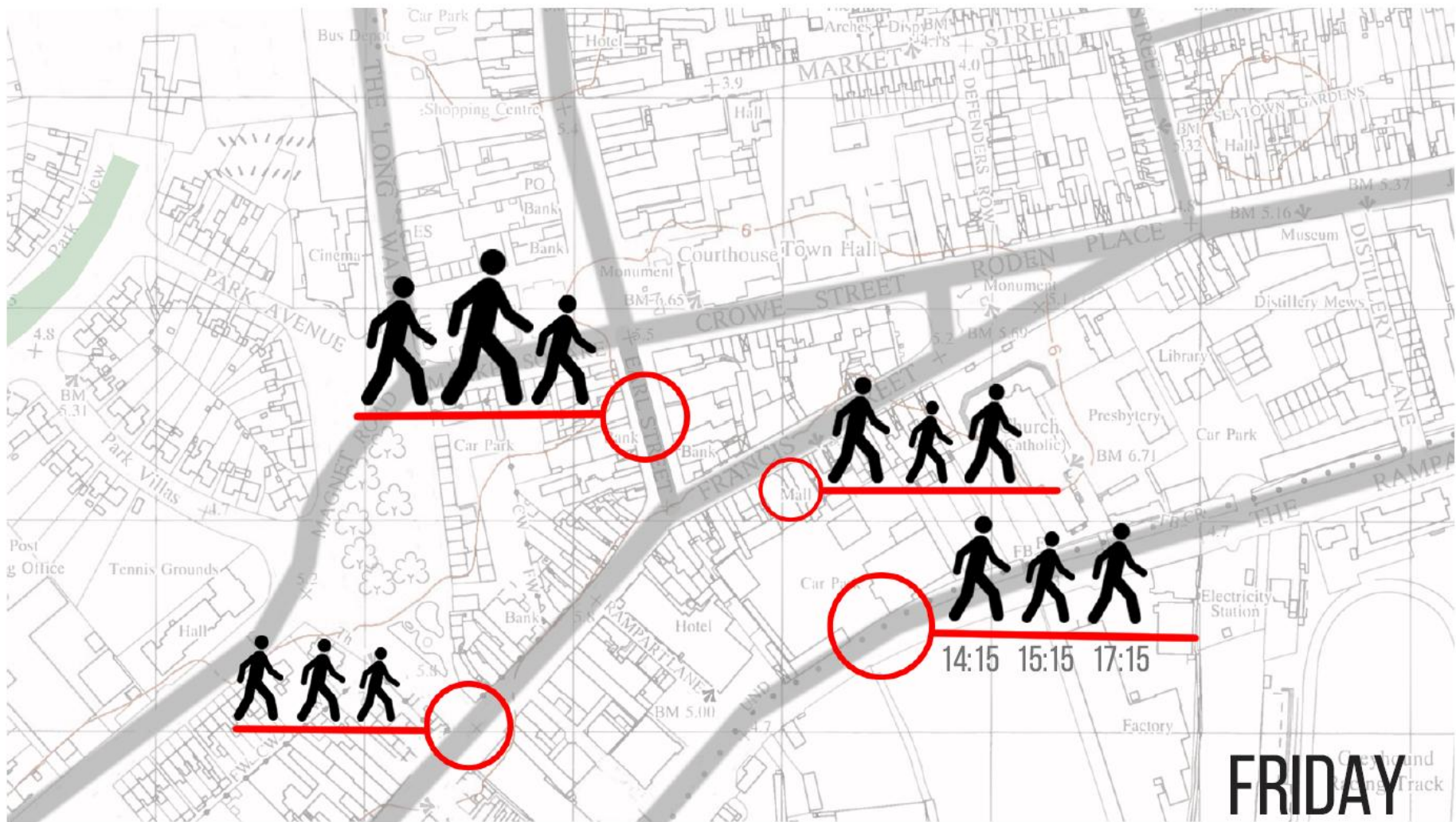



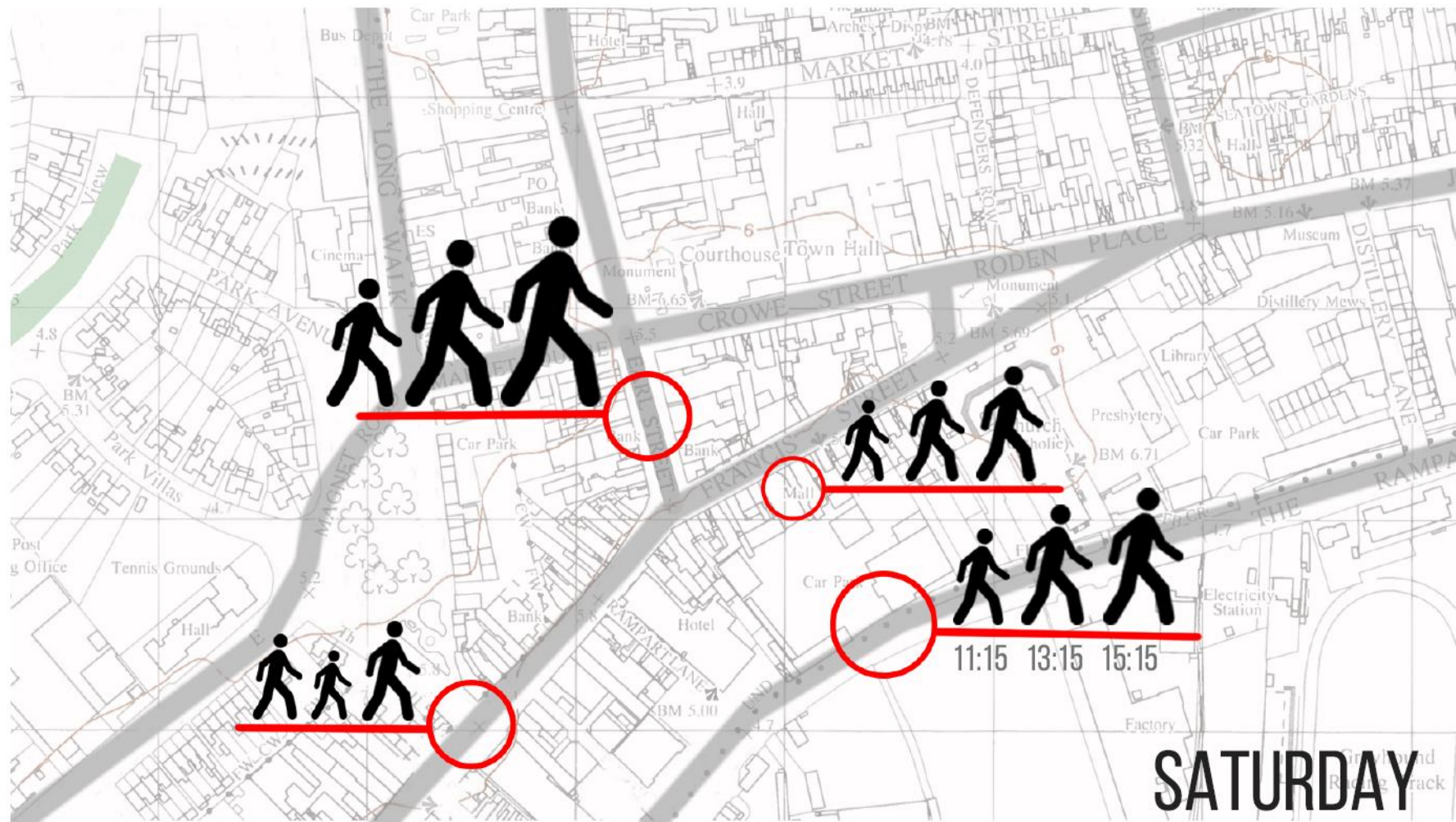









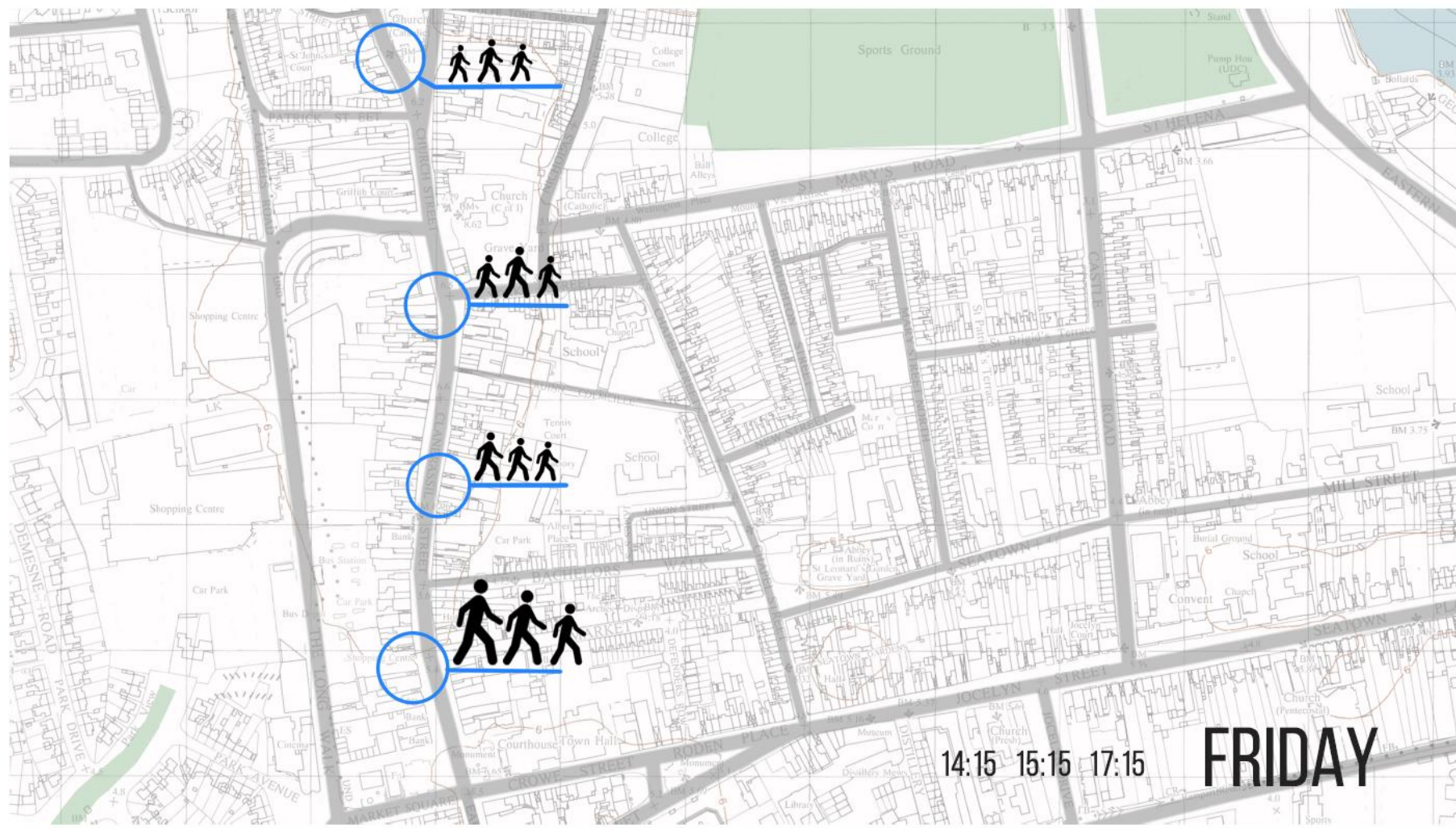

14:15 15:15 17:15

FRIDAY



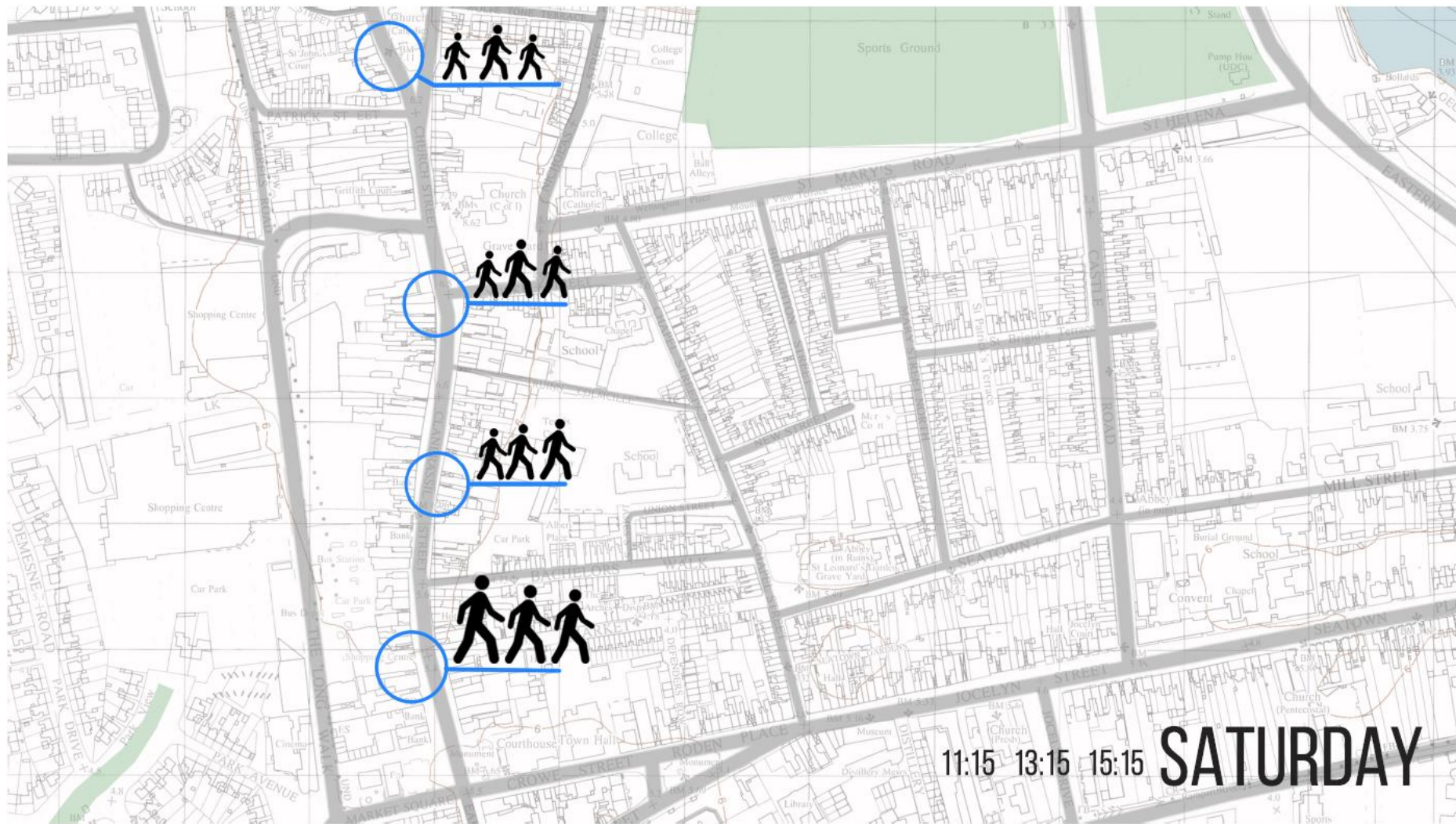

11:15 13:15 15:15

**SATURDAY**

# LAND USE



TOWN CENTRE HEALTH CHECK

---

DUNDALK, CO. LOUTH

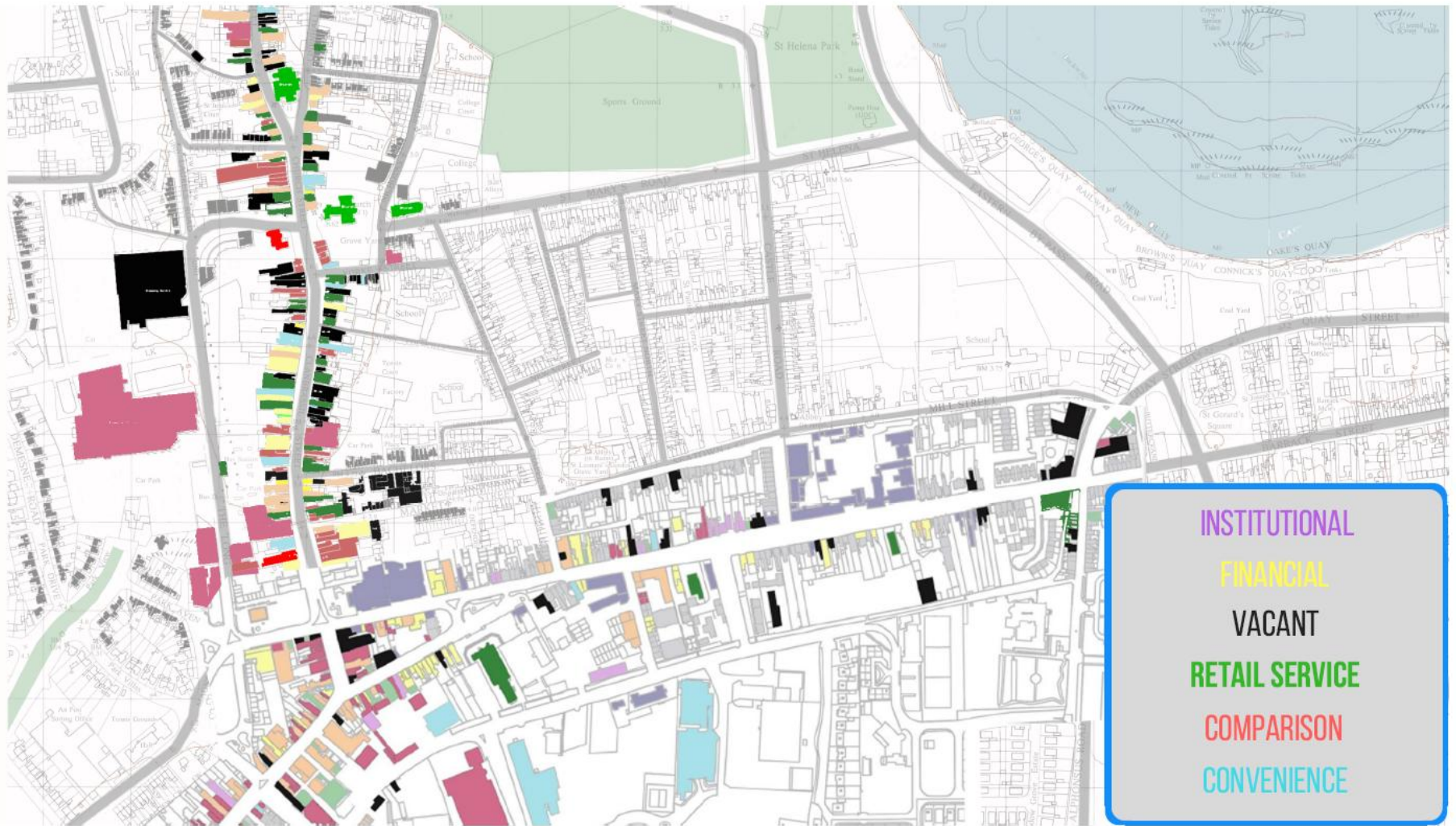



# PUBLIC REALM



TOWN CENTRE HEALTH CHECK

---

DUNDALK, CO. LOUTH

## HIGH QUALITY



PAVING



SEATING



STREETSCAPE

## LOW QUALITY



HARD EDGES



SURFACE



TIRED



# DIAGNOSIS

## DUNDALK TOWN CENTRE

Having concluded the Town Centre Health Check, we were in a position to diagnose issues within the town centre relevant to Urban Design parameters.



# VACANCY

## HIGH LEVELS WITHIN AREAS

- Clanbrassil Street
- Dearys
- Retail
- Out of centre outlets







# Connectivity

## MACRO AND MICRO

The ability to read a city or place is crucial in relation to its legibility and connectivity. Dundalk town centre suffers with issues of connectivity on both a Macro and Micro scale.



# MACRO TRAIN STATION



LEGIBILITY



DISORIENTATION



WAY FINDING

# Public Realm

## DISPARITY

Dundalk Town centre has firmly reshaped a successful and high quality public space in the form of Market Square, however this high standard of quality is polar opposite to many areas within the town core.





## PUBLIC REALM



ST. NICHOLAS



CLANBRASSIL ST



BRIDGE STREET

A grayscale background image of a cafe setting. In the foreground, a laptop is open on a table, with a notebook and a pen next to it. A glass of coffee is also visible. In the background, there are blurred figures of people and parked cars.

# MARY GILL

---

## MSc Urban Design



# Student Projects

Highlighting the projects of MSc  
Urban Design students

DUNDALK TOWN CENTRE



# An Insight

## PROBLEM SOLVING DESIGNS

Formulated from the results of the Town Centre Health Check and an Urban Analysis, MSc Urban Design students of Queen's University Belfast have conceptualised ideas to tackle and mitigate contemporary issues impacting the Town.



# VACANCY



RESILIENCE THROUGH TRADITION

---

DUNDALK TOWN CENTRE





# CONNECTIVITY



REESTABLISHING CONNECTIONS

---

DUNDALK TOWN CENTRE

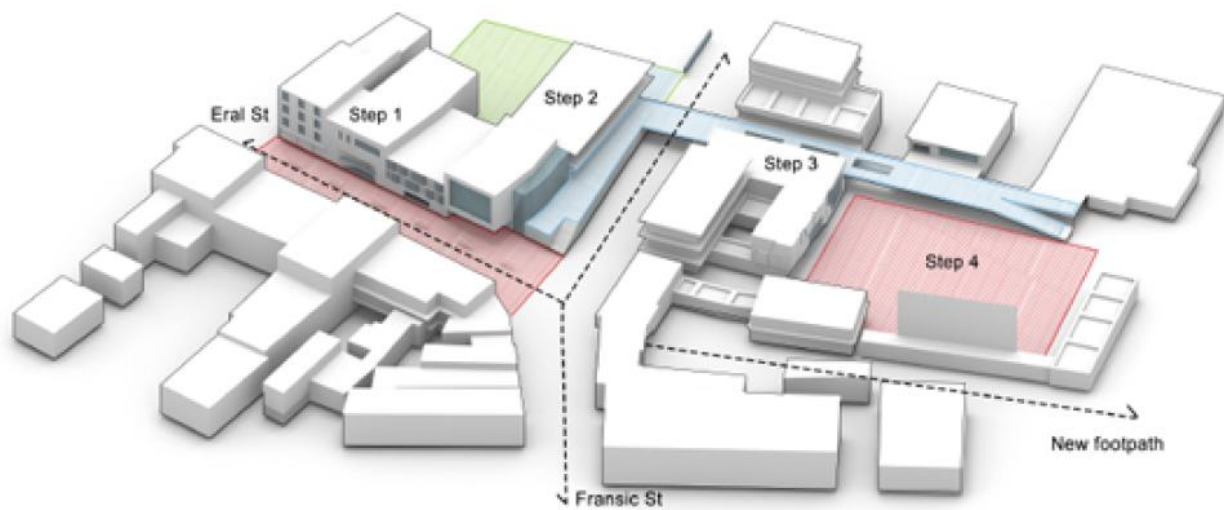
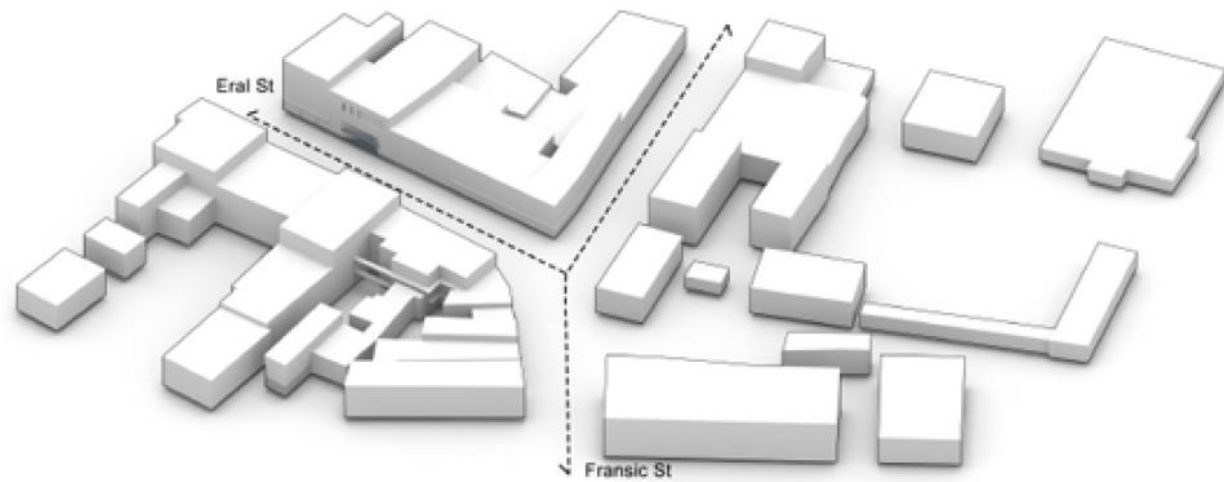

# BIRDVIEW MAP





# FINAL DESIGN PLAN

VERTICAL FARM  
CONNECTION ROUTE  
SHELTER ONE  
WATER WHEEL  
PRODUCE GROWING  
RIVER VIEWING SHELTER

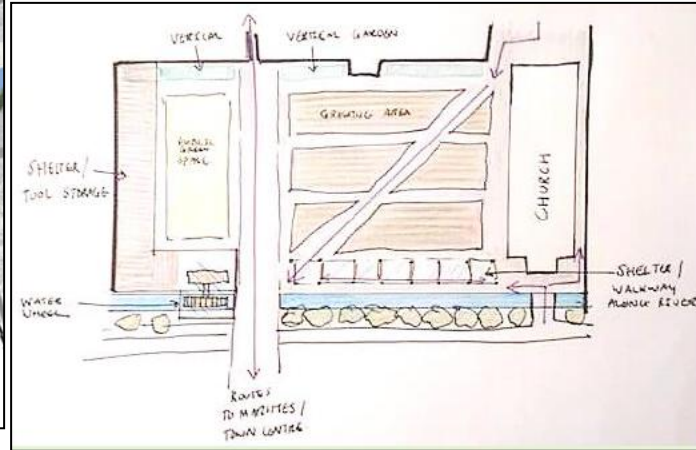
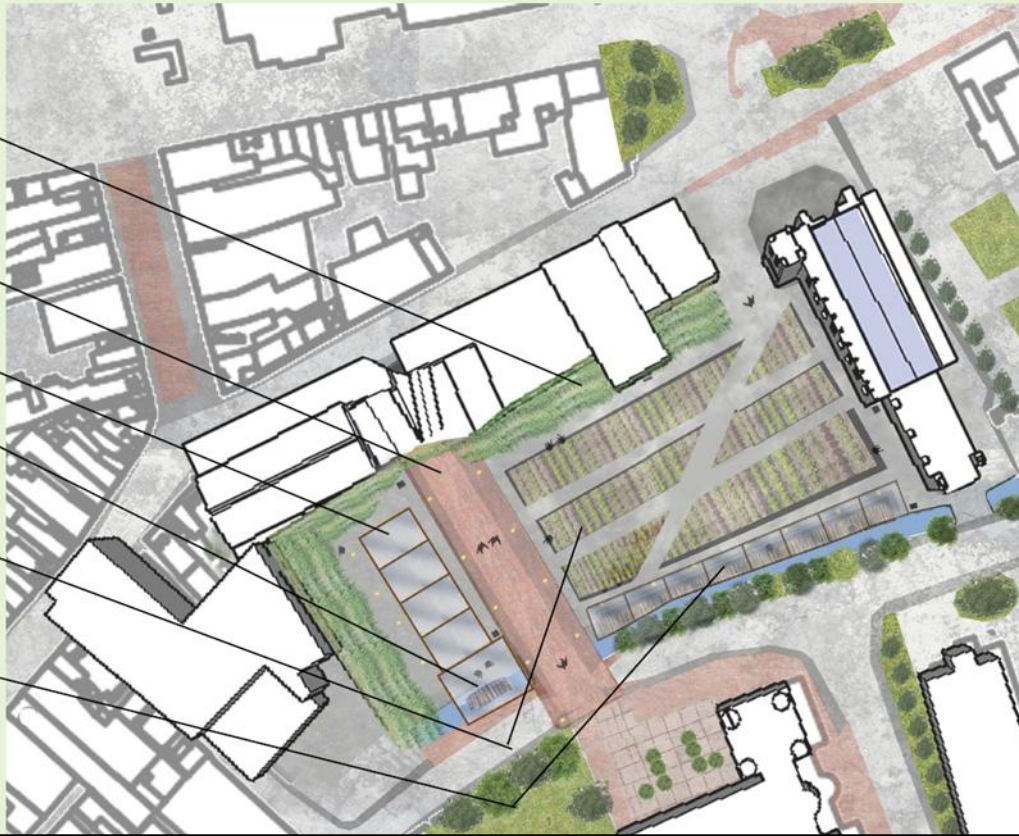

# Concept

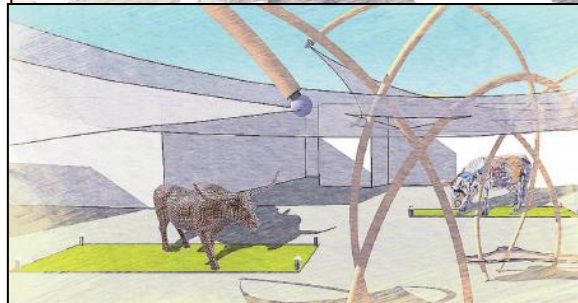
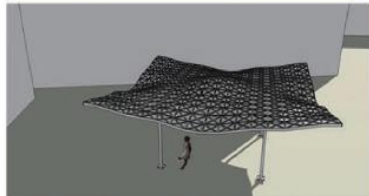
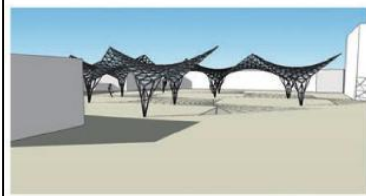
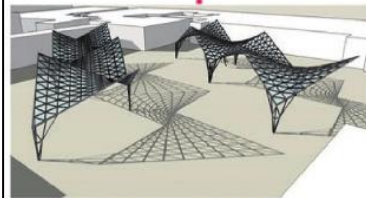

## Markets



## Music events



# PUBLIC REALM



CREATING PLACES FOR PEOPLE

---

DUNDALK TOWN CENTRE



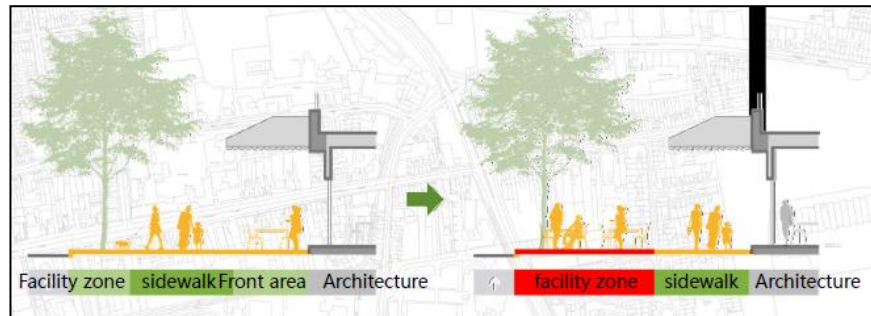



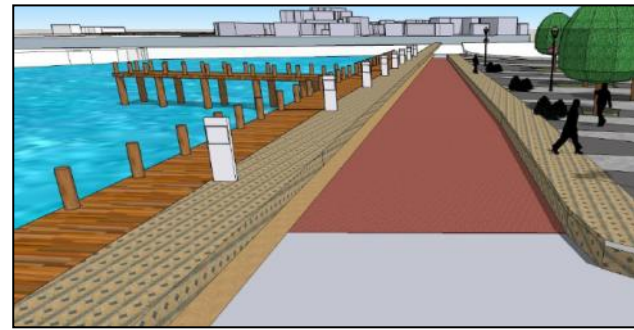
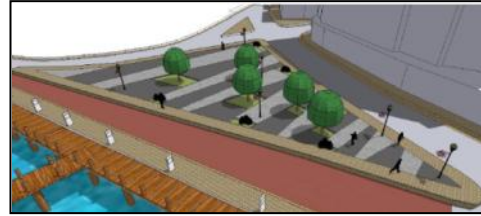

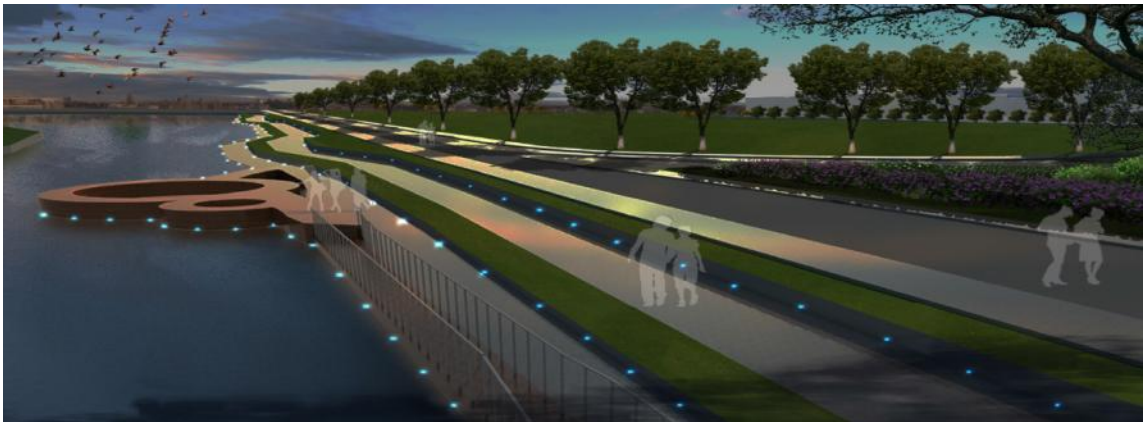



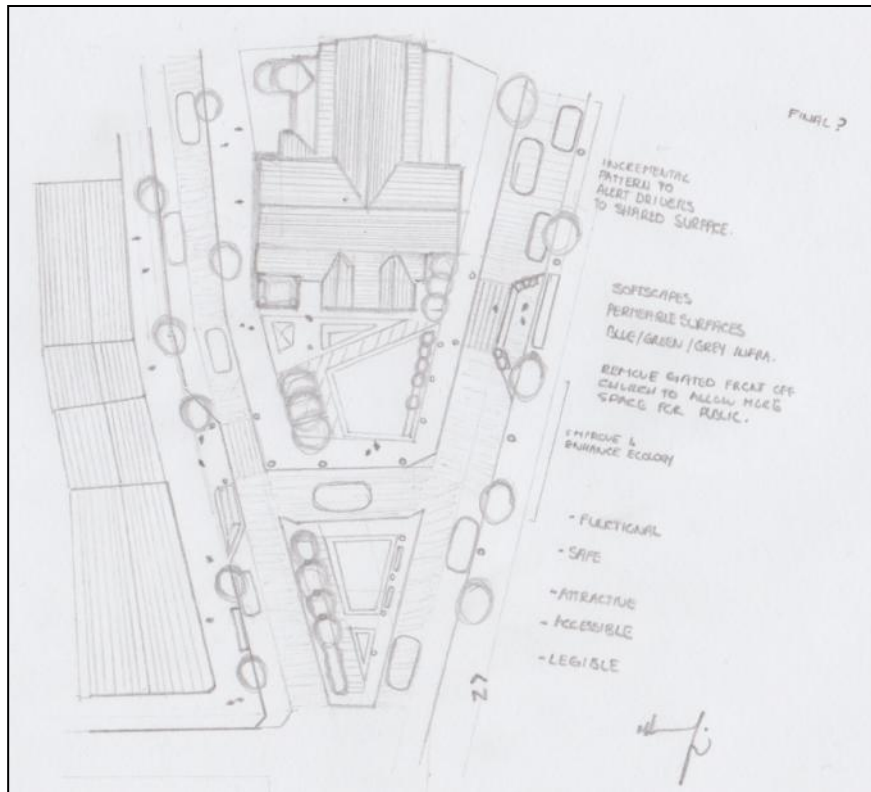

# Dundalk Co. Louth



A presentation over viewing the work carried out by MSc Urban Design students of Queen's University Belfast.

THANK YOU

