

# Dundalk Co. Louth

Town centre health check and  
urban design

MARCH 16, 2017 | DUBLIN CASTLE CONFERENCE CENTRE

# Introduction

## SYNOPSIS

A presentation to outline the work of Queen's University Belfast students carried out within Dundalk, Co. Louth. The project combines a Town Centre Health Check (TCHC) study along with Urban Design analysis and proposals.



# Acknowledgements

## CONTRIBUTERS

- Alison Harvey (Heritage Council)
- Brendan McSherry (Louth CoCo)
- Dundalk BIDS Team
- Peter Hutchinson (Irish Landscape Inst.)
- James Hennessy, Aiofe McGee & Tadhg Daly



# Study Context

## AREA OVERVIEW

- Second largest town in Ireland
- Largest town in Louth, but smaller than Drogheda
- Urban morphology & edge of centre retail outlets
- Marshes, Long Walk shopping centre and now vacant Carroll's Village Centre

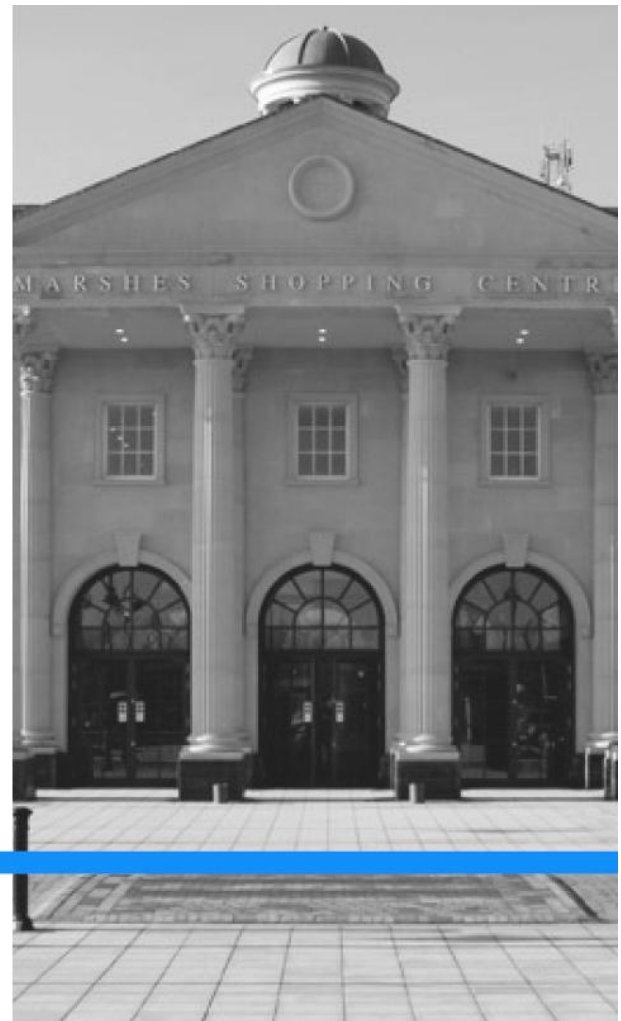





A detailed street map of an urban area. The map shows a grid of streets, green spaces, and a large body of water on the right. Three specific areas are highlighted in blue: one in the upper left, one in the middle left, and one in the lower left. The text 'CARROLL'S VILLAGE (VACANT)' is overlaid in the center, and 'LONG WALK CENTRE' is overlaid below it. 'MARSHES CENTRE' is overlaid at the bottom left, and '€ RETAIL OUTLETS' is overlaid at the bottom right.

**CARROLL'S VILLAGE (VACANT)**

**LONG WALK CENTRE**

**MARSHES CENTRE**

**€ RETAIL OUTLETS**

# Carroll's Village

## VACANT RETAIL OUTLET

A vacant 2,984 SqM retail unit. Located within Carroll Village Shopping Centre, off the Long Walk and adjacent to the retail thoroughfares of Clanbrassil Street and Earl Street in the heart of Dundalk town.



# Student Brief

## CORE ELEMENTS

- Pilot project with MSc Urban Design module.
- Analysis | Strategies | Individual design proposals.
- TCHC for Dundalk town centre.
- Survey work.
- 2 day overnight trip.

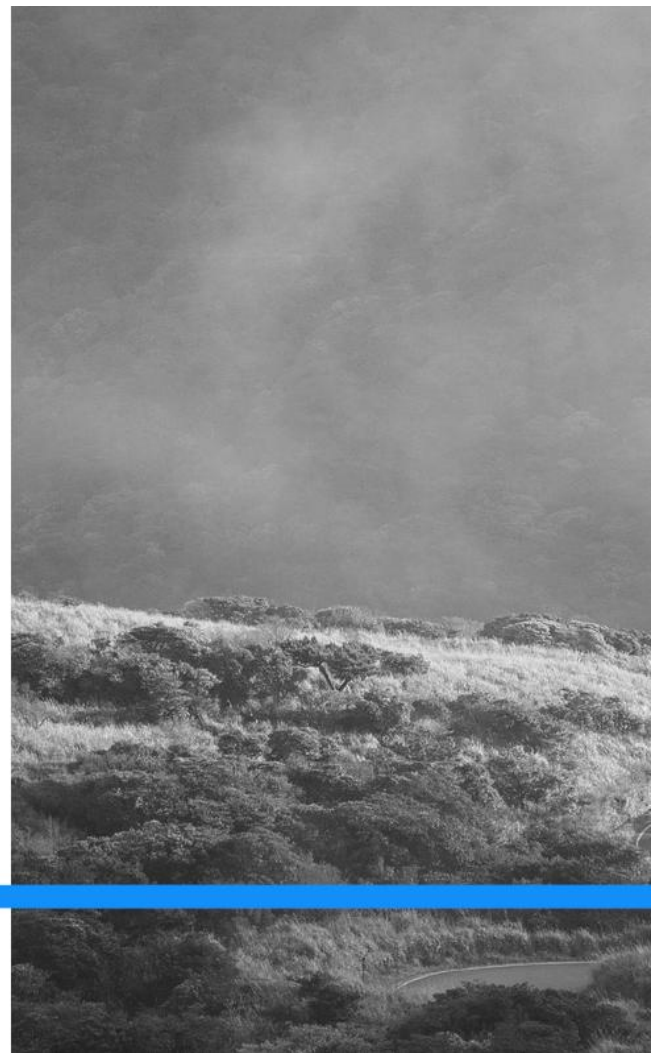



# Study Area

## LOCATION & CONTEXT

Primarily shaped by agreed parameters provided by Louth County Council in order to assist with the TCHC. The study had particular focus on Dundalk town centre with additional site specific locations.





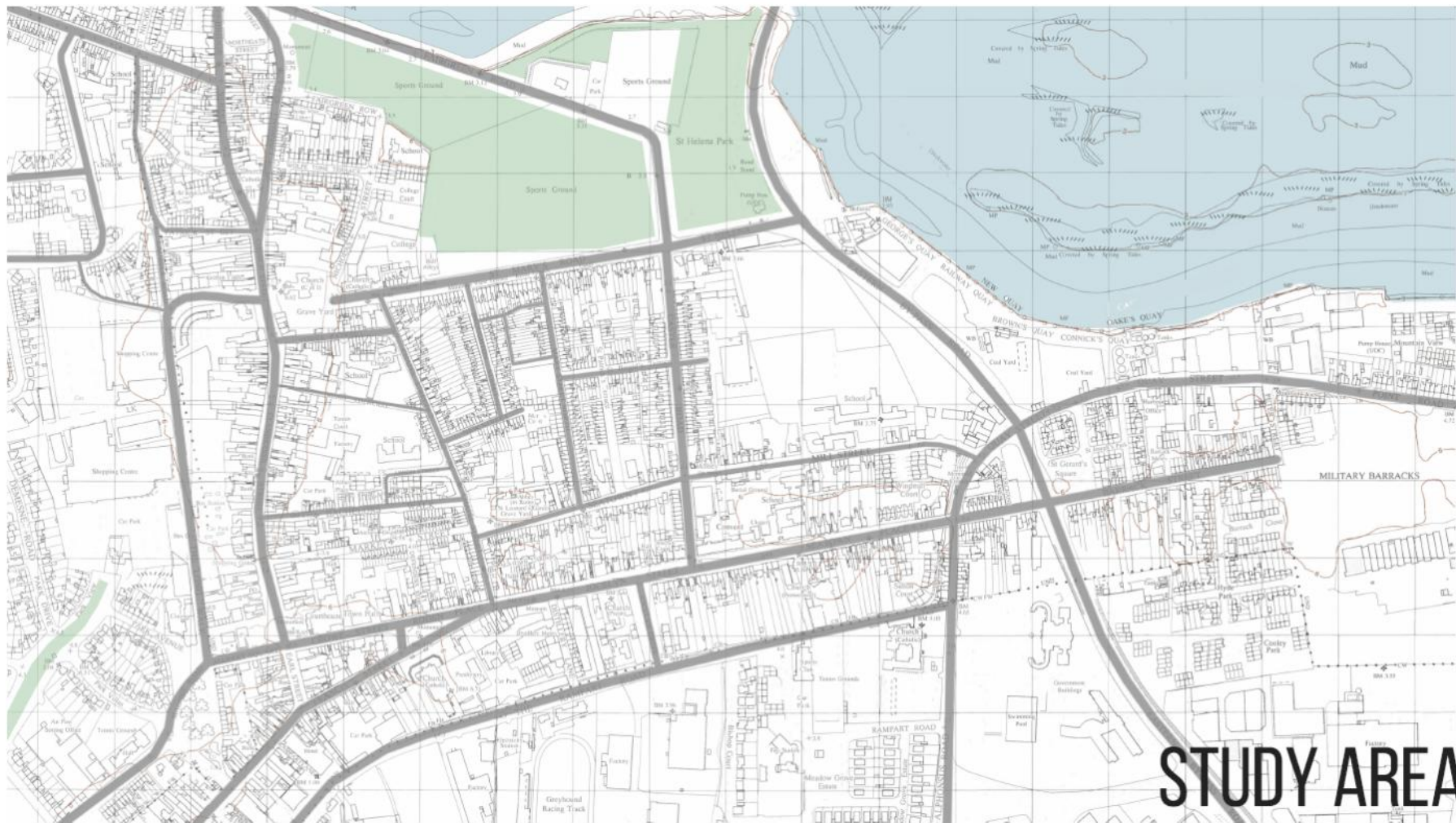

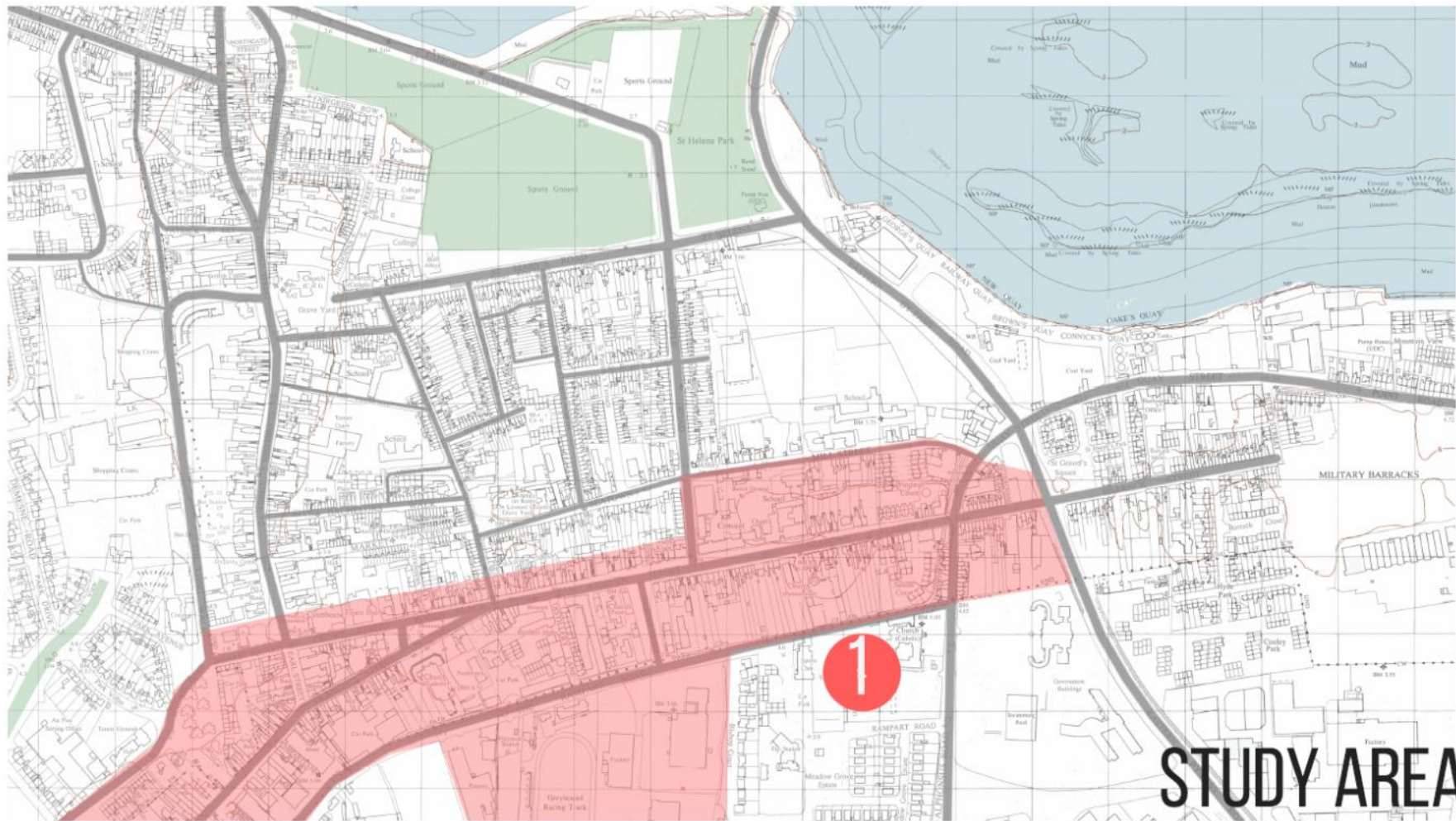

**STUDY AREA**



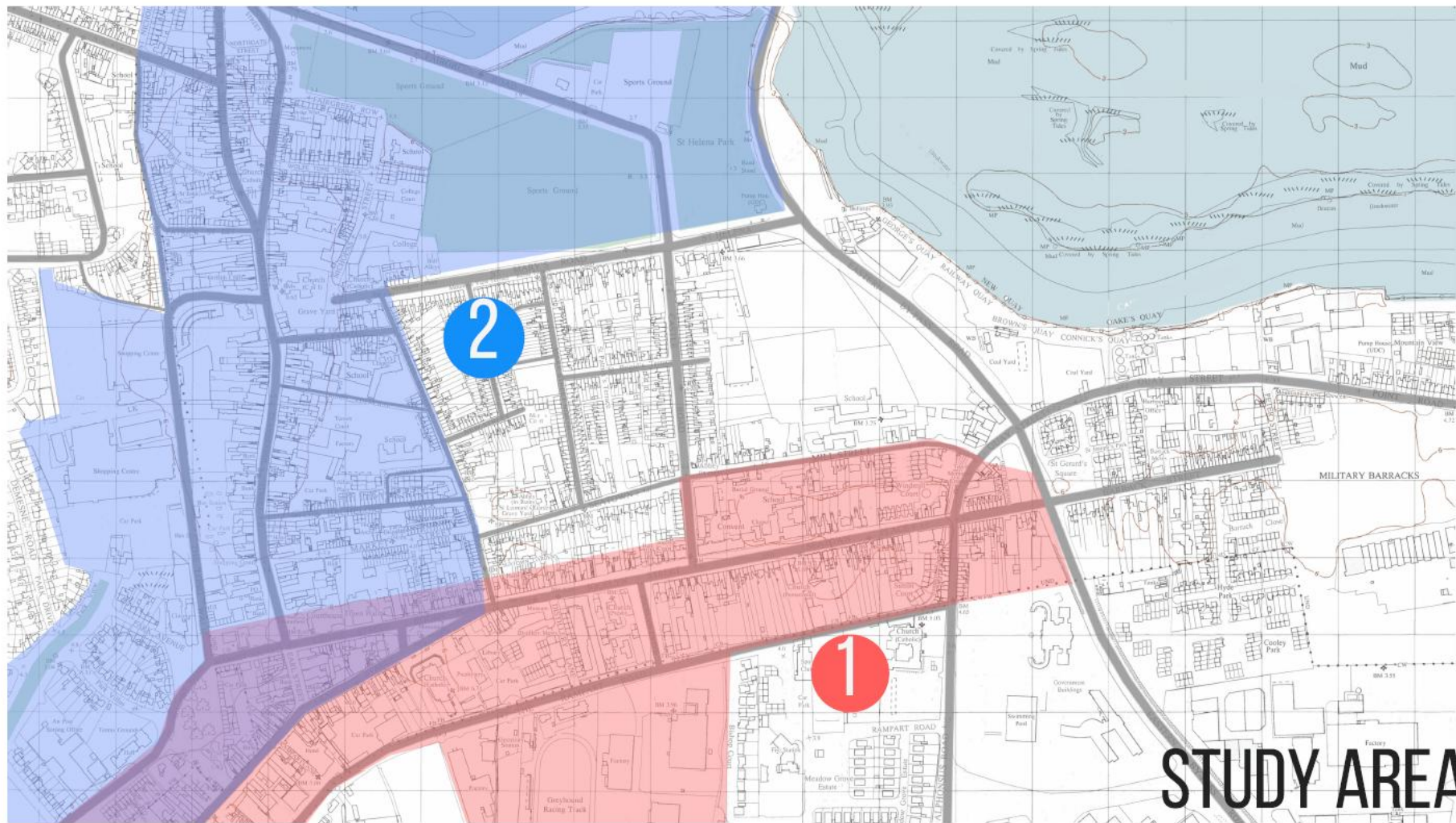

# STUDY AREA

A historical map of a coastal area, likely in the 19th century. The map is divided into three main colored regions: a blue-shaded area on the left labeled 'ST. NICHOLAS', a purple-shaded area in the center labeled 'DEARYS', and a red-shaded area on the right labeled 'MARSHES'. Three red circles are drawn on the map: one in the blue area, one in the purple area, and one in the red area. The map shows various streets, buildings, and landmarks. Key features include 'St Helena Park' and 'Sports Ground' in the blue area; 'Grave Yard', 'School', and 'Town Hall' in the purple area; and 'MILITARY BARRACKS', 'RAMPART ROAD', and 'Meadow Grove Estate' in the red area. The right side of the map shows a body of water with 'Mud' areas and 'Quays' (George's Quay, Brown's Quay, Connick's Quay, Oak's Quay).

ST. NICHOLAS

DEARYS

MARSHES

STUDY AREA



# KEY SITES



ST.NICHOLAS



MARSHES



DEARYS



**Matthew Harvey**

---

MSc Urban Design

**Cultures & climates differ all over  
the world, but people are the same.  
They'll gather in public if you give  
them a good place to do it**

JAN GEHL - ARCHITECT

---

# TCHC and Diagnosis

DUNDALK, CO. LOUTH

An overview of the results and key findings of the Town Centre Health Check (TCHC), followed by a town centre diagnosis.





## CORE ELEMENTS OF TCHC



FOOTFALL



LAND USE



PUBLIC REALM

# FOOTFALL



TOWN CENTRE HEALTH CHECK

---

DUNDALK, CO. LOUTH





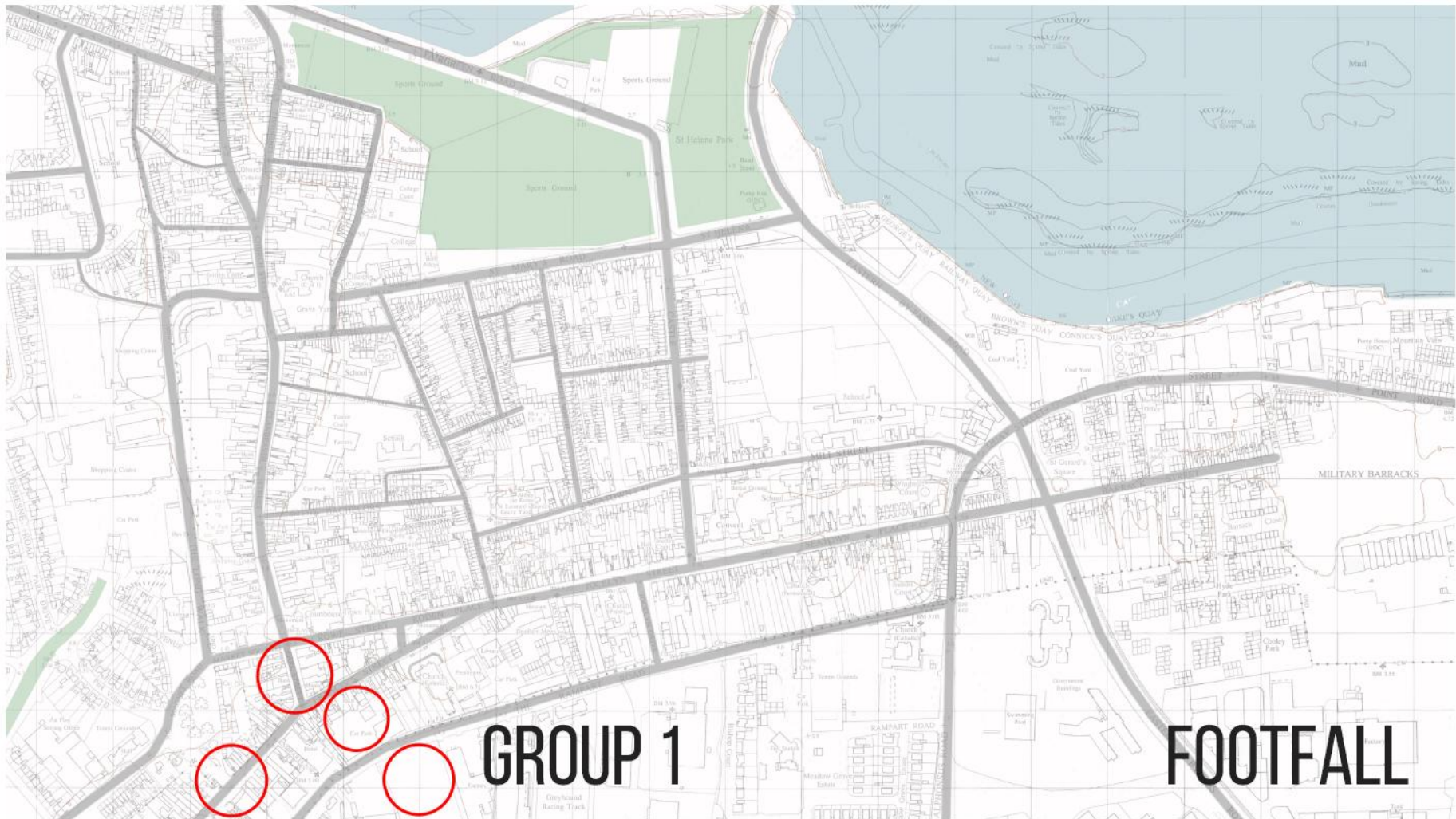

GROUP 1

FOOTFALL







A detailed map of an urban area, likely a coastal town, showing streets, buildings, and green spaces. The map is overlaid with a grid. Several locations are marked with circles: three blue circles along a central vertical road and five red circles along a road at the bottom. The text 'GROUP 2' is centered over the blue circles, and 'GROUP 1' is centered over the red circles. The text 'FOOTFALL' is in the bottom right corner. The map includes labels for various landmarks such as 'Sports Ground', 'St Helena Park', 'MILITARY BARRACKS', and 'RAMPART ROAD'. The coastline is visible on the right side, with labels like 'Mud' and 'Mud' indicating low-lying areas.

**GROUP 2**

**GROUP 1**

**FOOTFALL**







**FRIDAY** Greyhound  
Racing Track



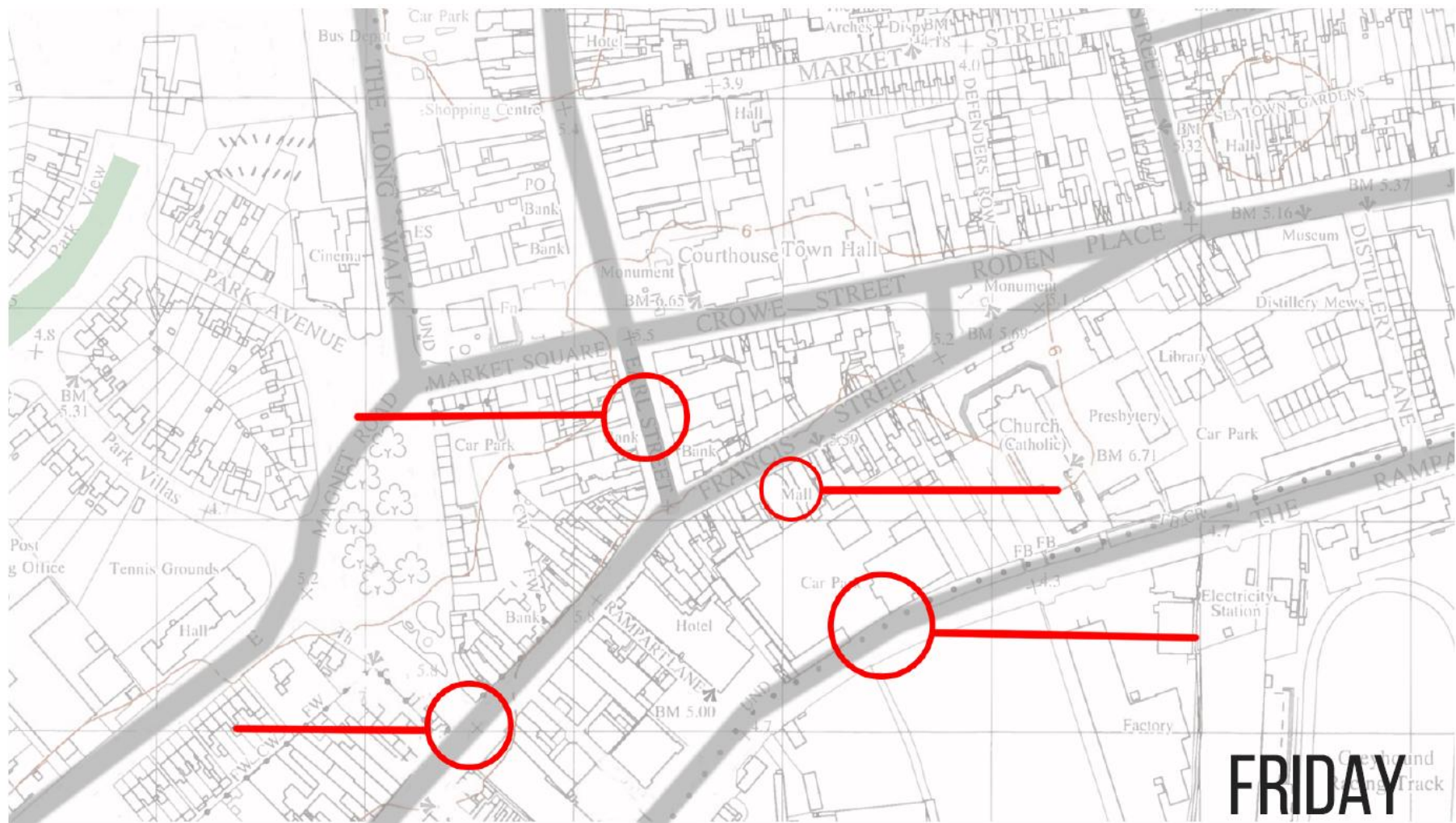

FRIDAY

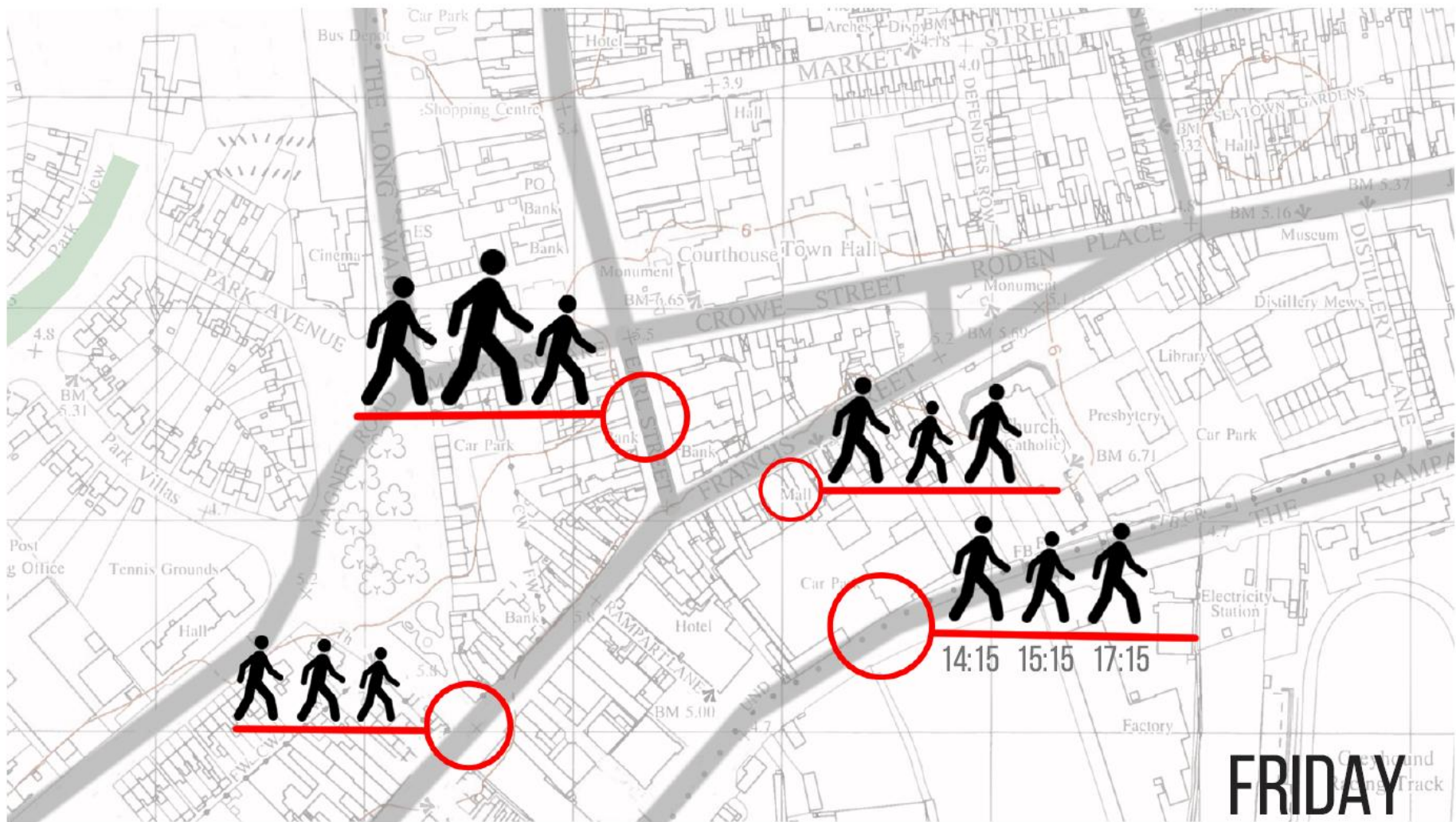

FRIDAY



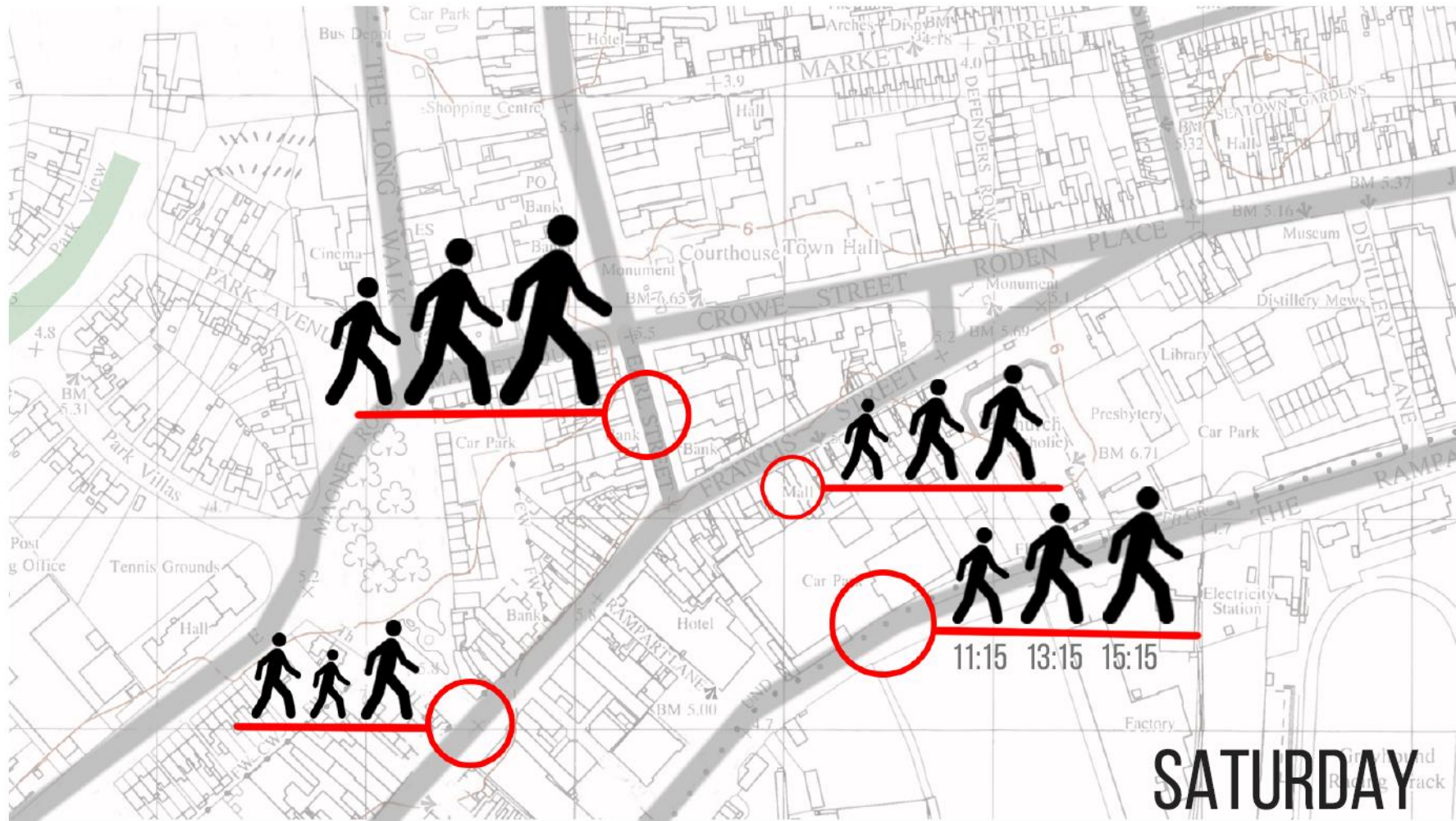





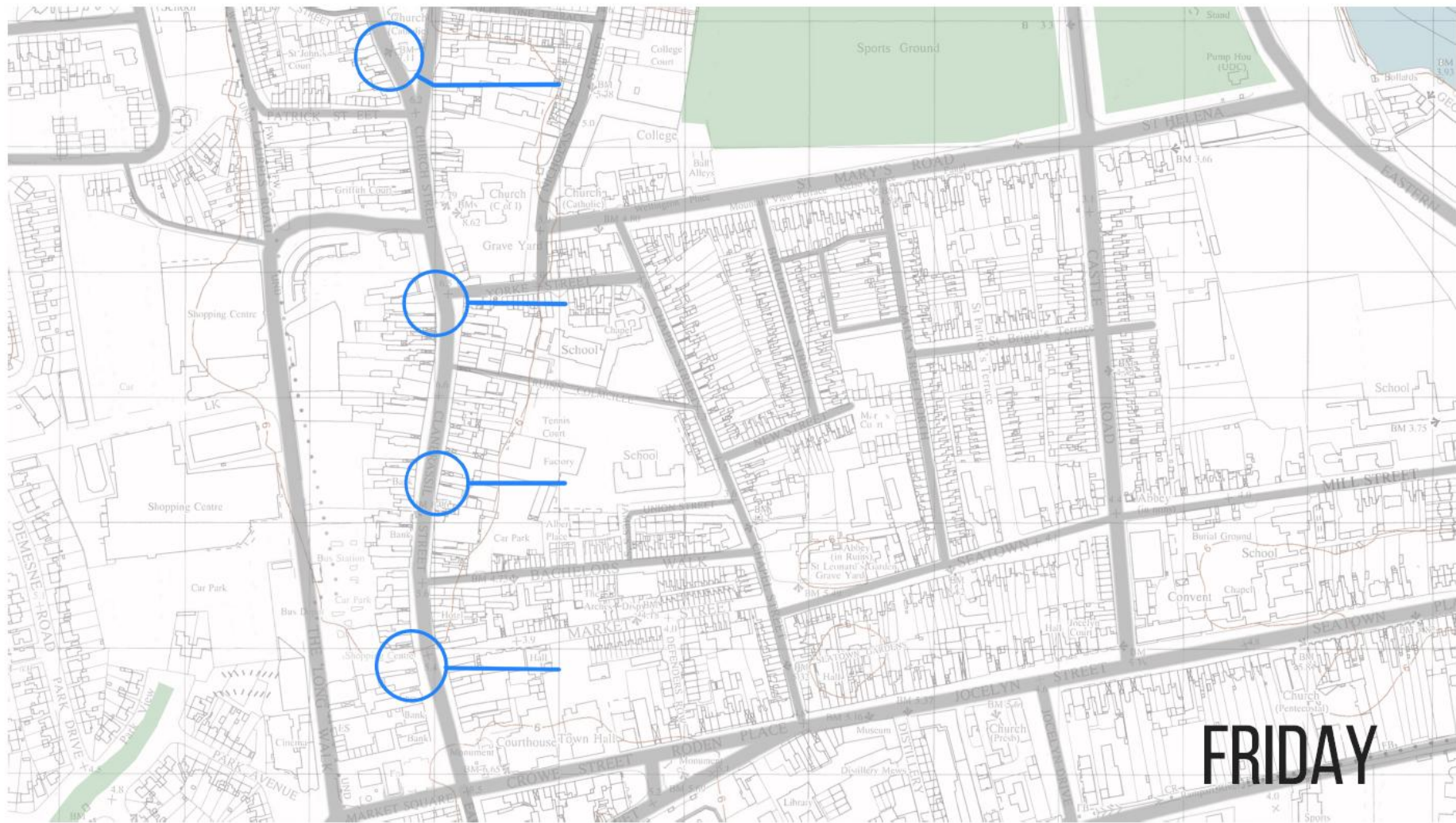

FRIDAY

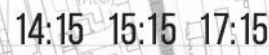

# FRIDAY



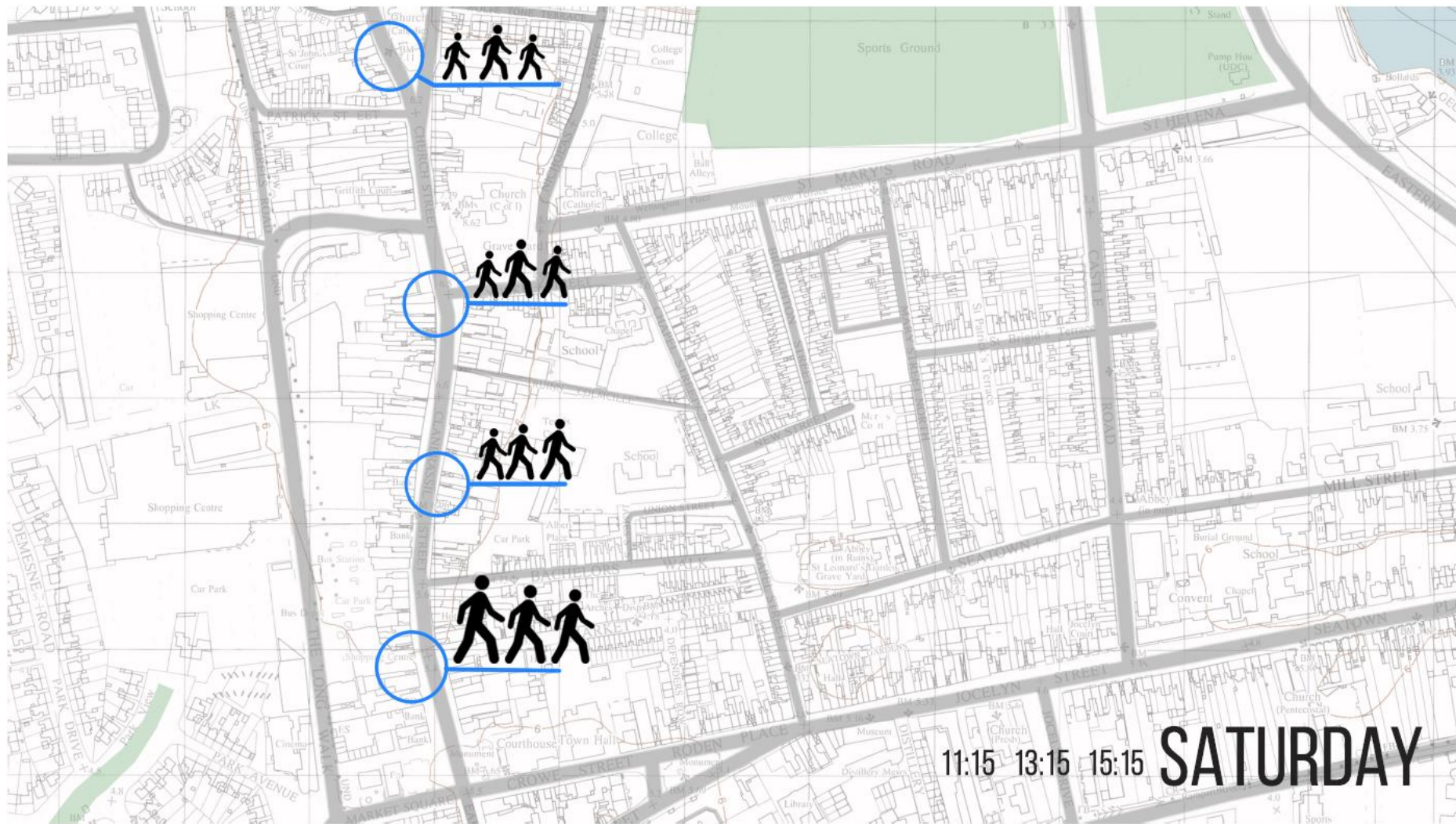

# LAND USE



TOWN CENTRE HEALTH CHECK

---

DUNDALK, CO. LOUTH



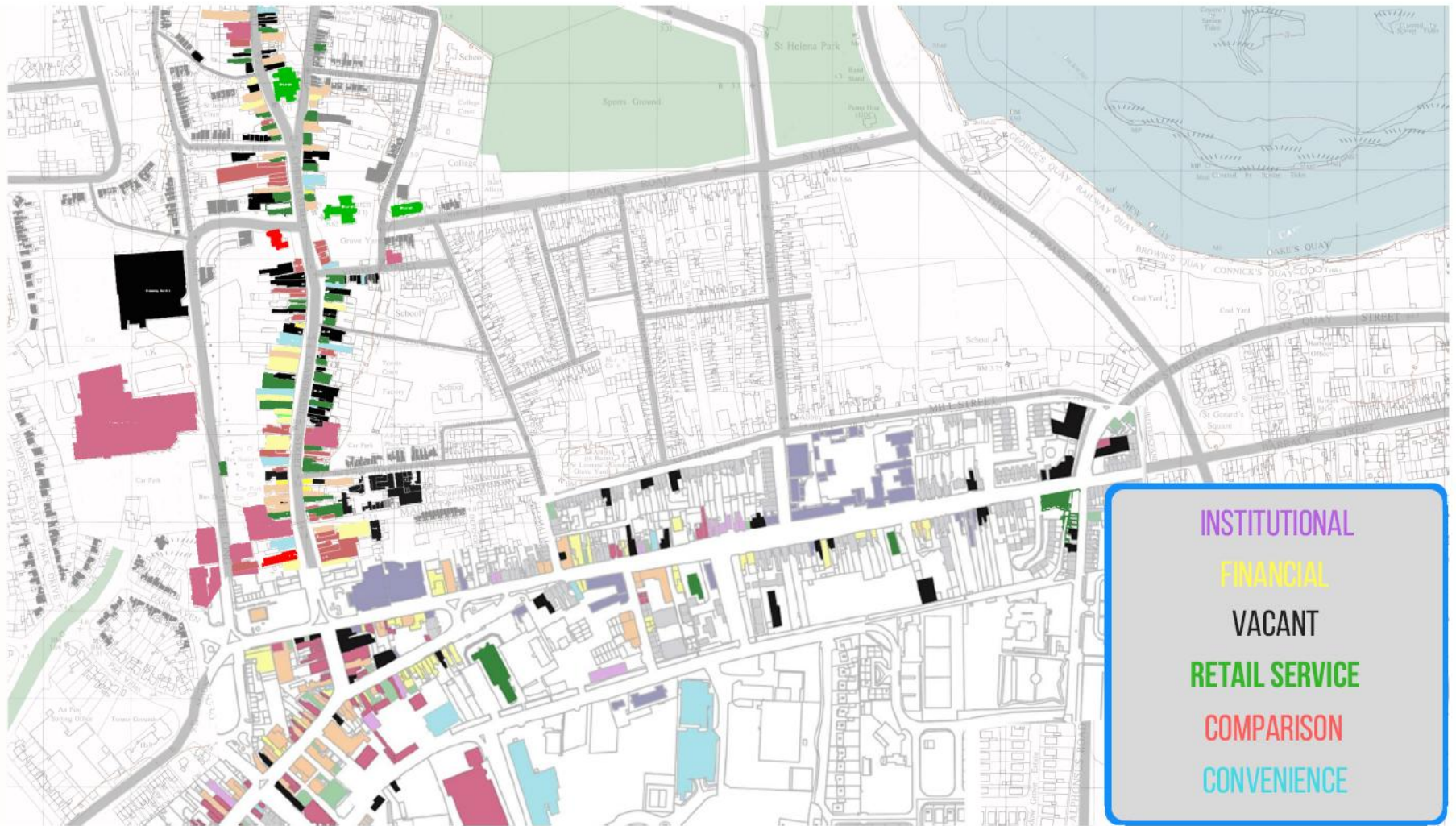

INSTITUTIONAL

FINANCIAL

VACANT

RETAIL SERVICE

COMPARISON

CONVENIENCE

# PUBLIC REALM



TOWN CENTRE HEALTH CHECK

---

DUNDALK, CO. LOUTH

## HIGH QUALITY



PAVING



SEATING



STREETSCAPE



## LOW QUALITY



HARD EDGES



SURFACE



TIRED

# DIAGNOSIS

## DUNDALK TOWN CENTRE

Having concluded the Town Centre Health Check, we were in a position to diagnose issues within the town centre relevant to Urban Design parameters.

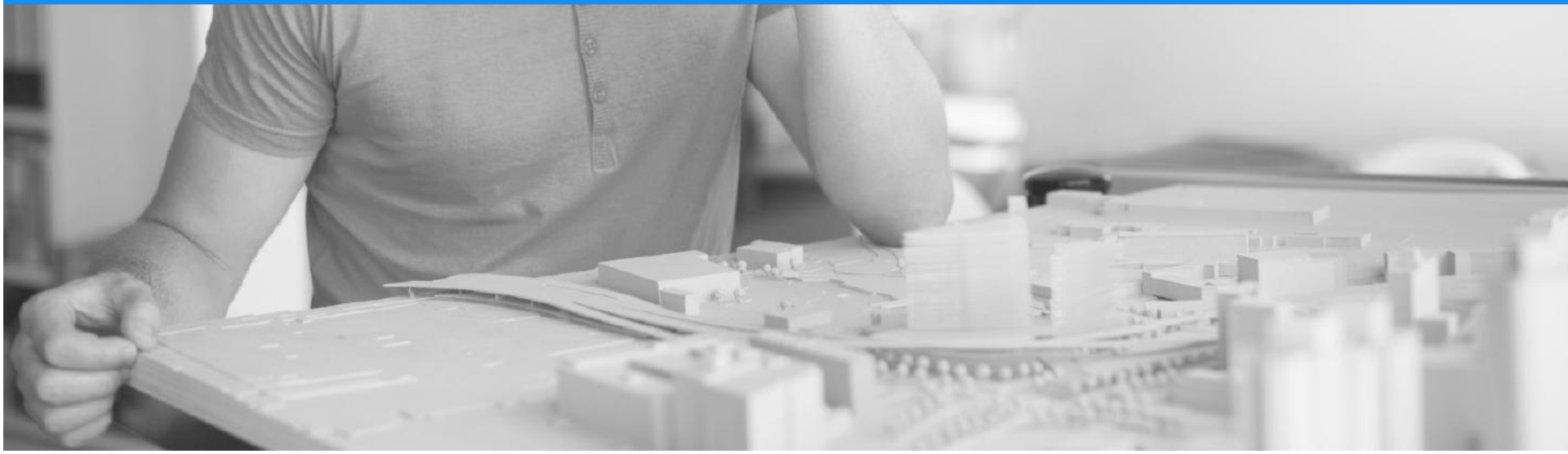

# VACANCY

## HIGH LEVELS WITHIN AREAS

- Clanbrassil Street
- Dearys
- Retail
- Out of centre outlets







# Connectivity

## MACRO AND MICRO

The ability to read a city or place is crucial in relation to its legibility and connectivity. Dundalk town centre suffers with issues of connectivity on both a Macro and Micro scale.



# MACRO TRAIN STATION



LEGIBILITY



DISORIENTATION



WAY FINDING



# Public Realm

## DISPARITY

Dundalk Town centre has firmly reshaped a successful and high quality public space in the form of Market Square, however this high standard of quality is polar opposite to many areas within the town core.



## PUBLIC REALM



ST. NICHOLAS



CLANBRASSIL ST



BRIDGE STREET



**MARY GILL**

---

MSc Urban Design





# Student Projects

Highlighting the projects of MSc  
Urban Design students

DUNDALK TOWN CENTRE

# An Insight

## PROBLEM SOLVING DESIGNS

Formulated from the results of the Town Centre Health Check and an Urban Analysis, MSc Urban Design students of Queen's University Belfast have conceptualised ideas to tackle and mitigate contemporary issues impacting the Town.



# VACANCY



RESILIENCE THROUGH TRADITION

---

DUNDALK TOWN CENTRE





# CONNECTIVITY



REESTABLISHING CONNECTIONS

---

DUNDALK TOWN CENTRE

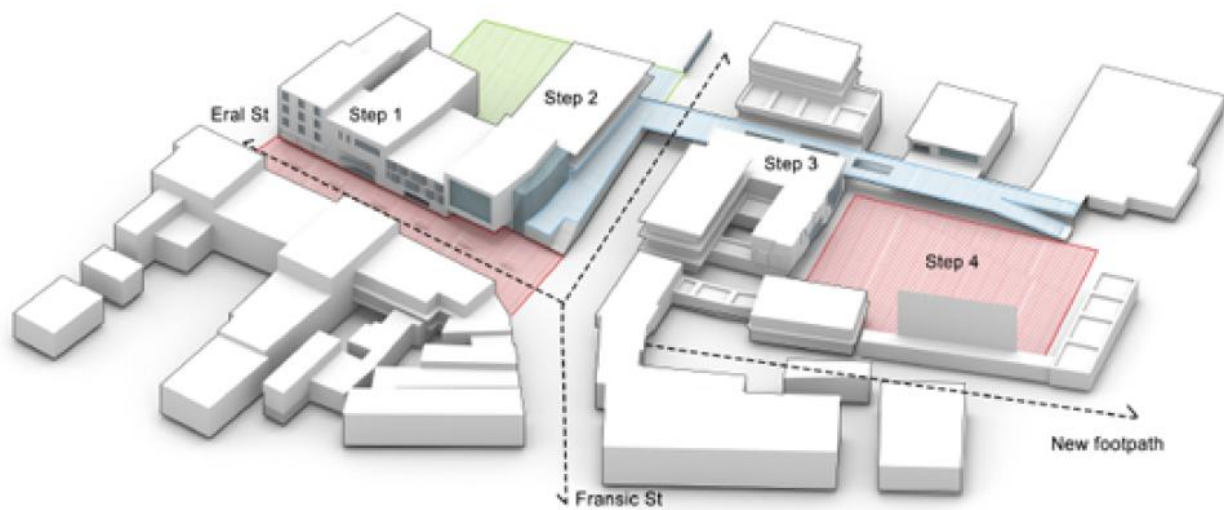
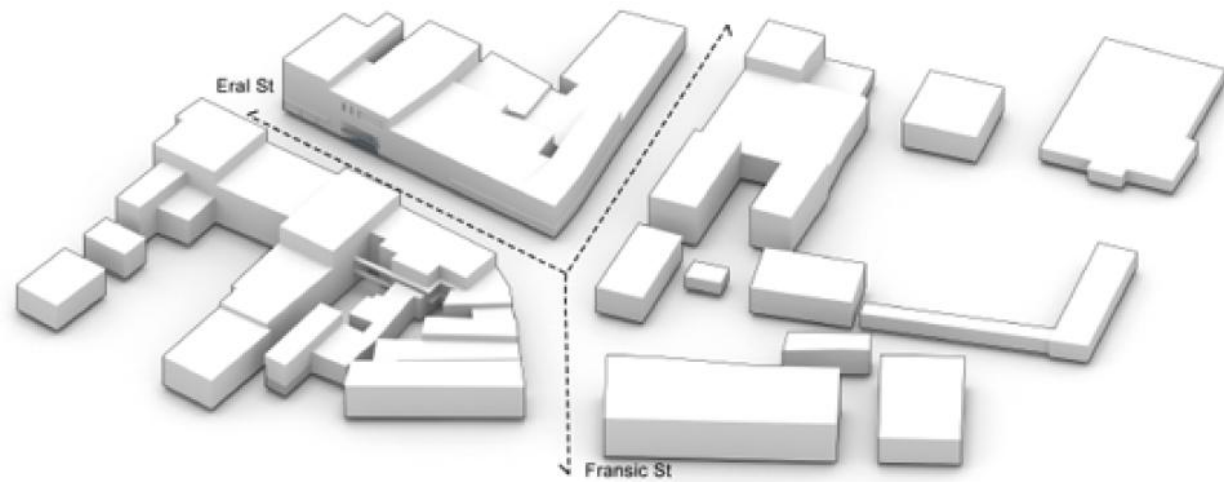



# BIRDVIEW MAP



# FINAL DESIGN PLAN

VERTICAL FARM  
CONNECTION ROUTE  
SHELTER ONE  
WATER WHEEL  
PRODUCE GROWING  
RIVER VIEWING SHELTER

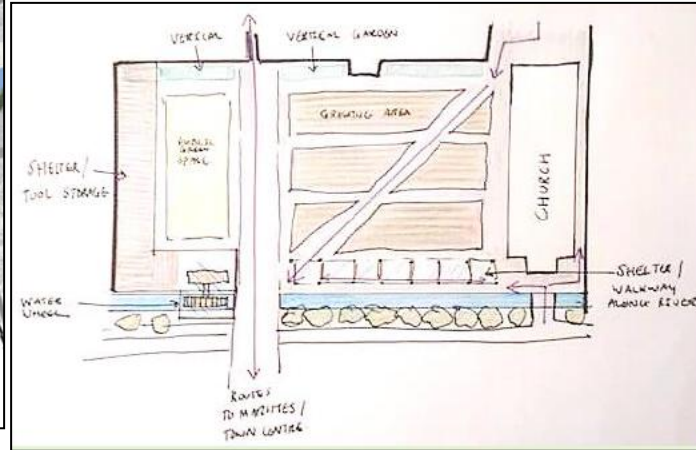
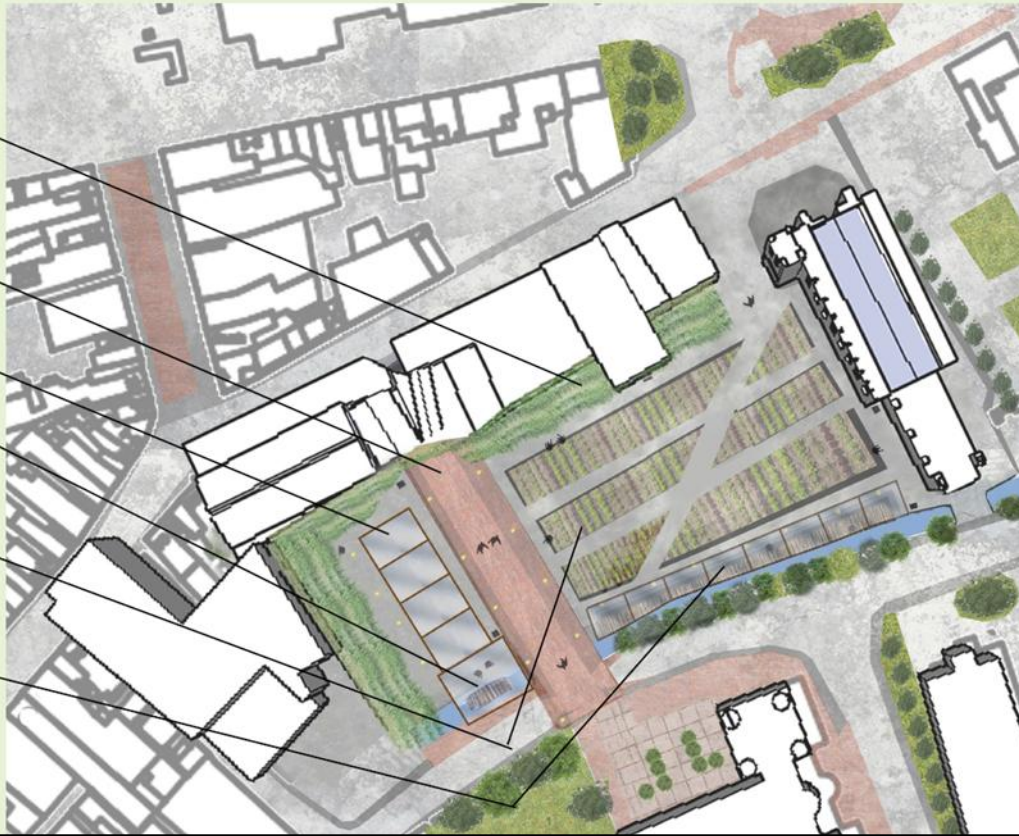



# Concept

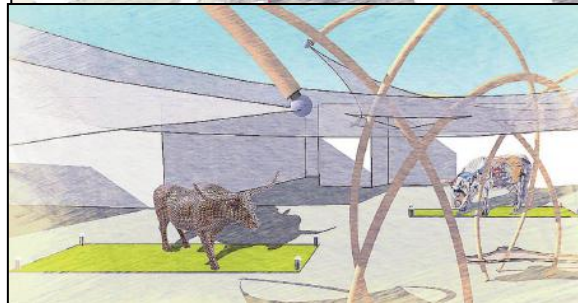
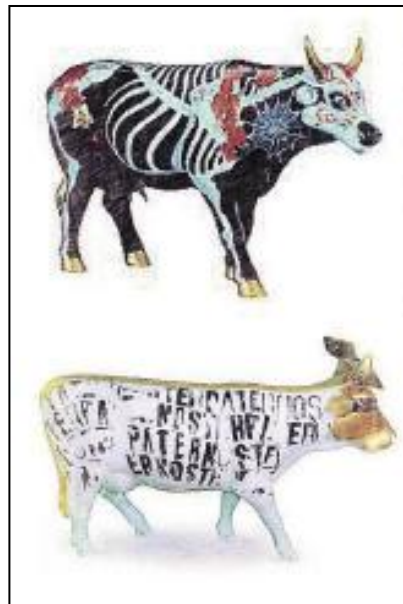
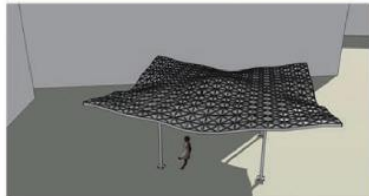
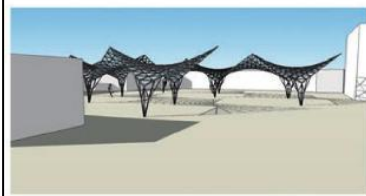
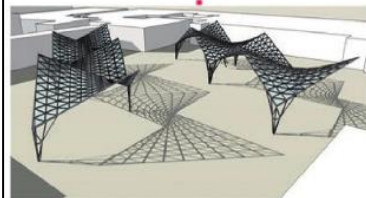
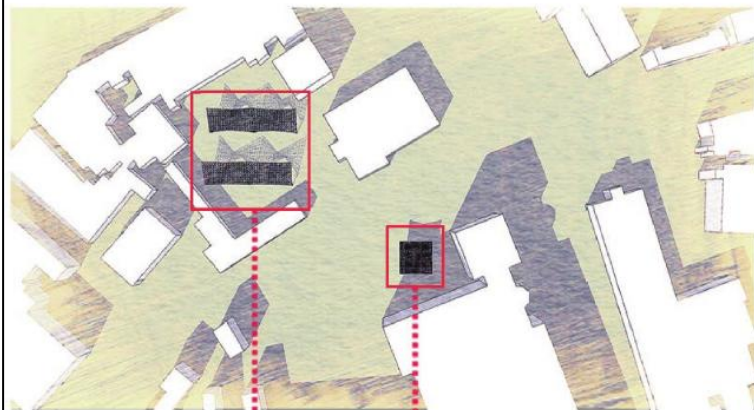

## Markets



## Music events





# PUBLIC REALM



CREATING PLACES FOR PEOPLE

---

DUNDALK TOWN CENTRE

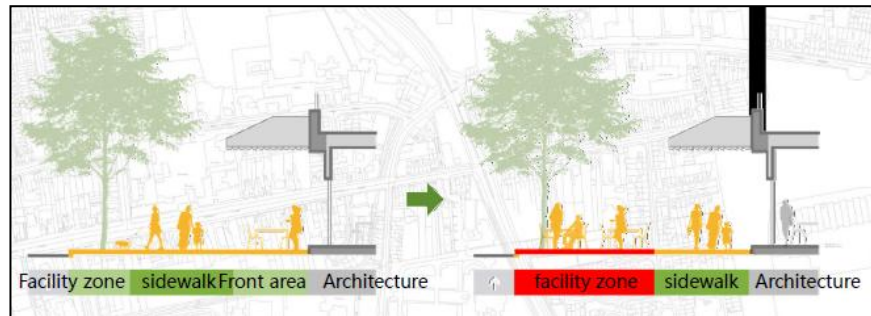



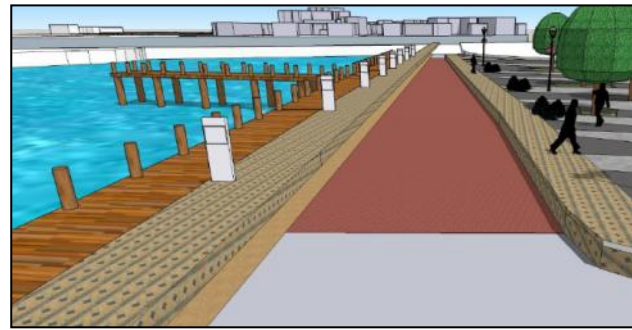
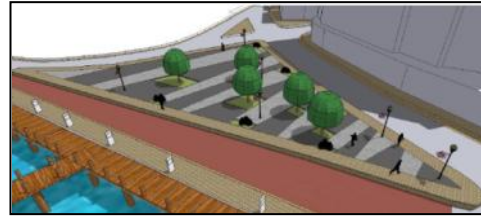



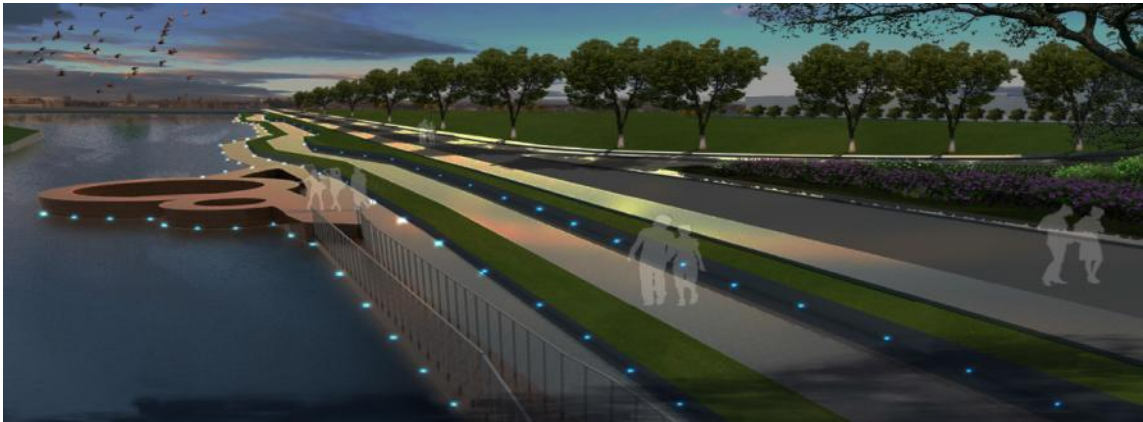

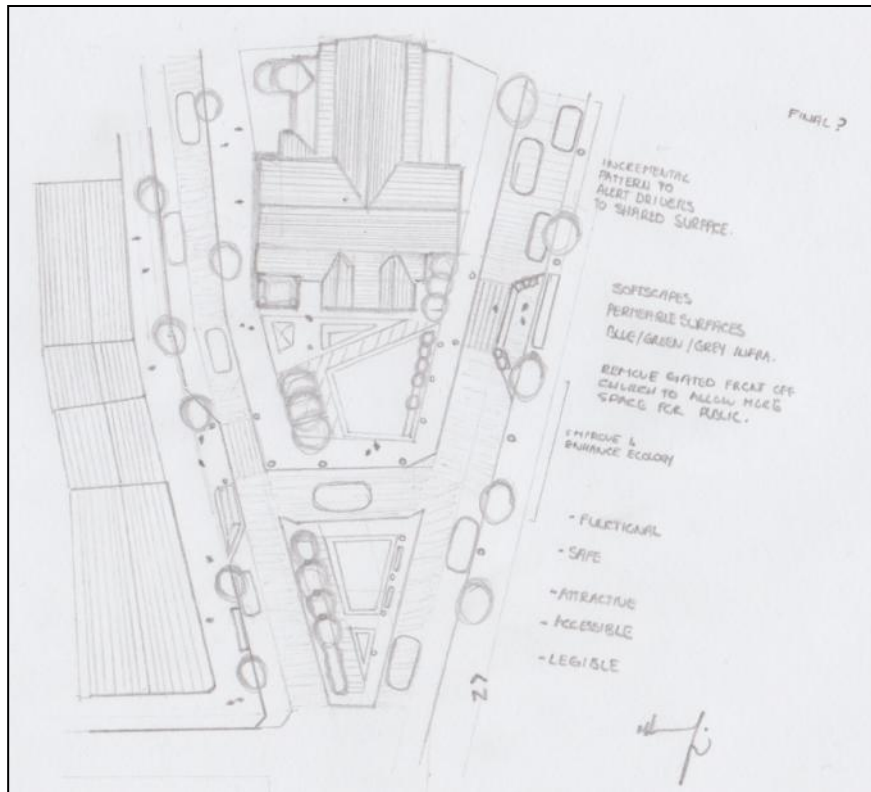

# Dundalk Co. Louth



A presentation over viewing the work carried out by MSc Urban Design students of Queen's University Belfast.

THANK YOU

