

An Roinn Ealaíon, Oidhreachta,
Gnóthai Réigiúnacha, Tuaithe agus Gaeltachta
Department of Arts, Heritage,
Regional, Rural and Gaeltacht Affairs

Revitalising Ireland's Towns
Pilot Town Centre Health Check (TCHC)
16th March 2017

Developing a Design-Led Approach to Adaptive National Policies

Martin Colreavy

Dip Arch BArch Sc MSc Urban Design MRIAI

Principal Advisor

Built Heritage, Architectural Policy & Strategic Infrastructure

Department of Arts, Heritage, Regional, Rural and Gaeltacht Affairs









The Urban Age project – the Endless City

- Population of the State 1996 – 2006
- 3.6m to 4.3m, 17% increase
- Unevenly throughout the Gateways, Cities and Counties
- Largest growth in Fingal County, Galway City, South Dublin with Cork City reduction

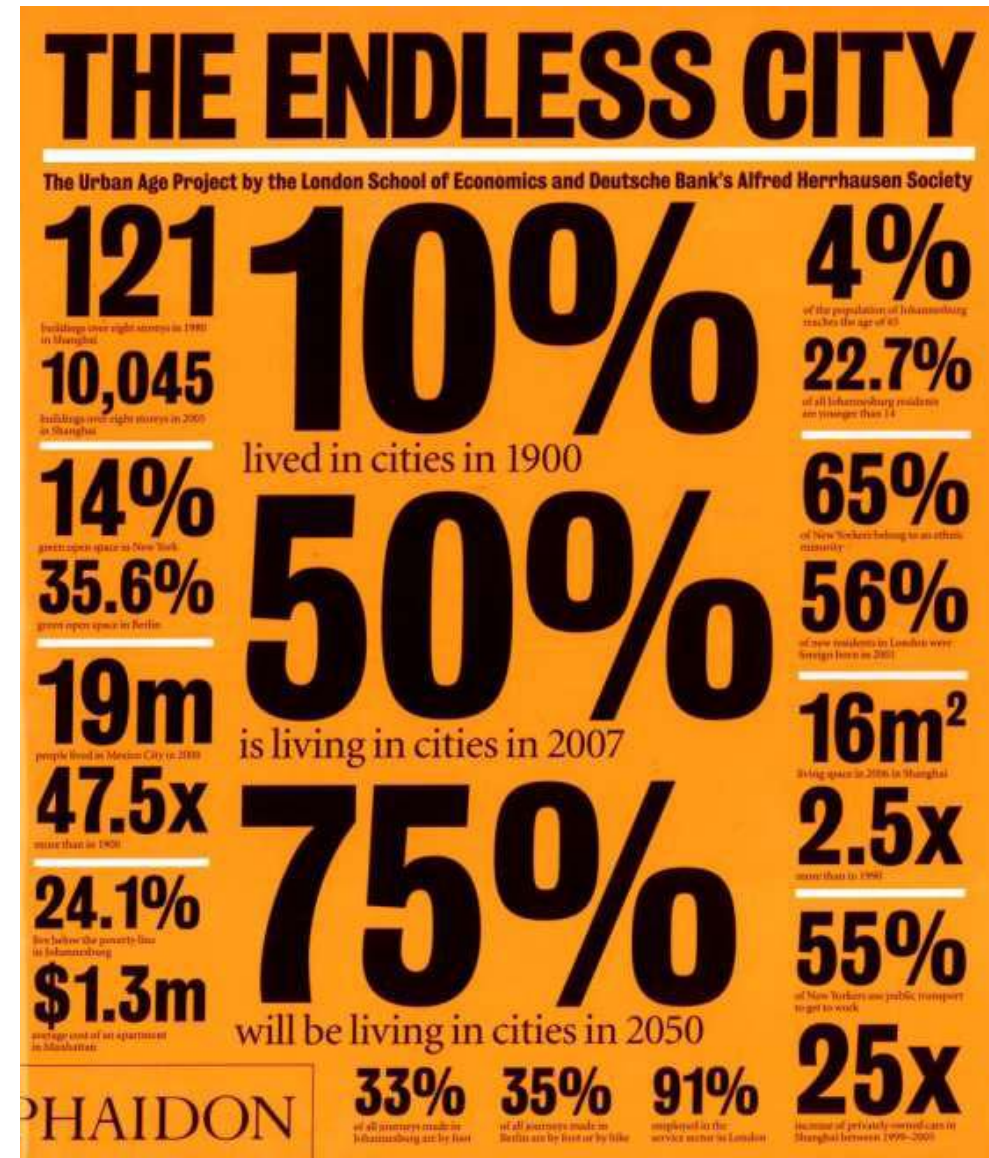



"We're waiting for the city to come to us..."

Urban Design and Environmental Health Impacts

Figure 1: The determinants of health and well-being in our neighbourhoods*

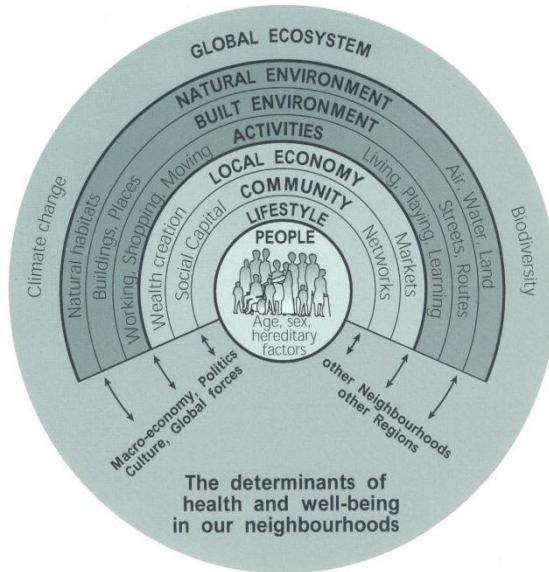
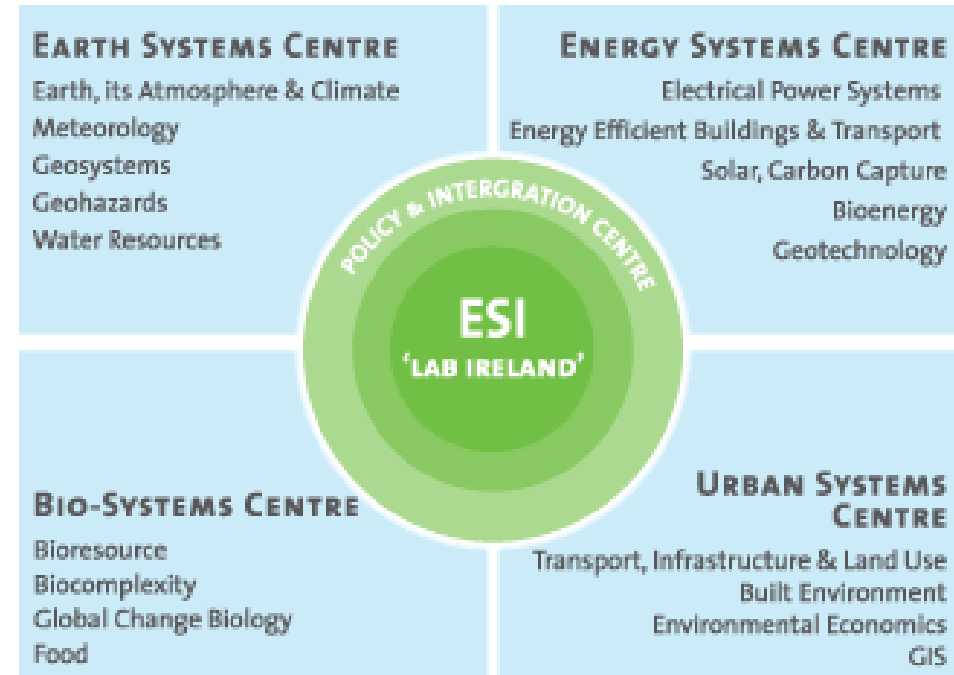

Diagram by Barton, H & Grant, M, 2006, derived from Whitehead, M & Dahlgren, G, The determinants of health and well-being, 1991.









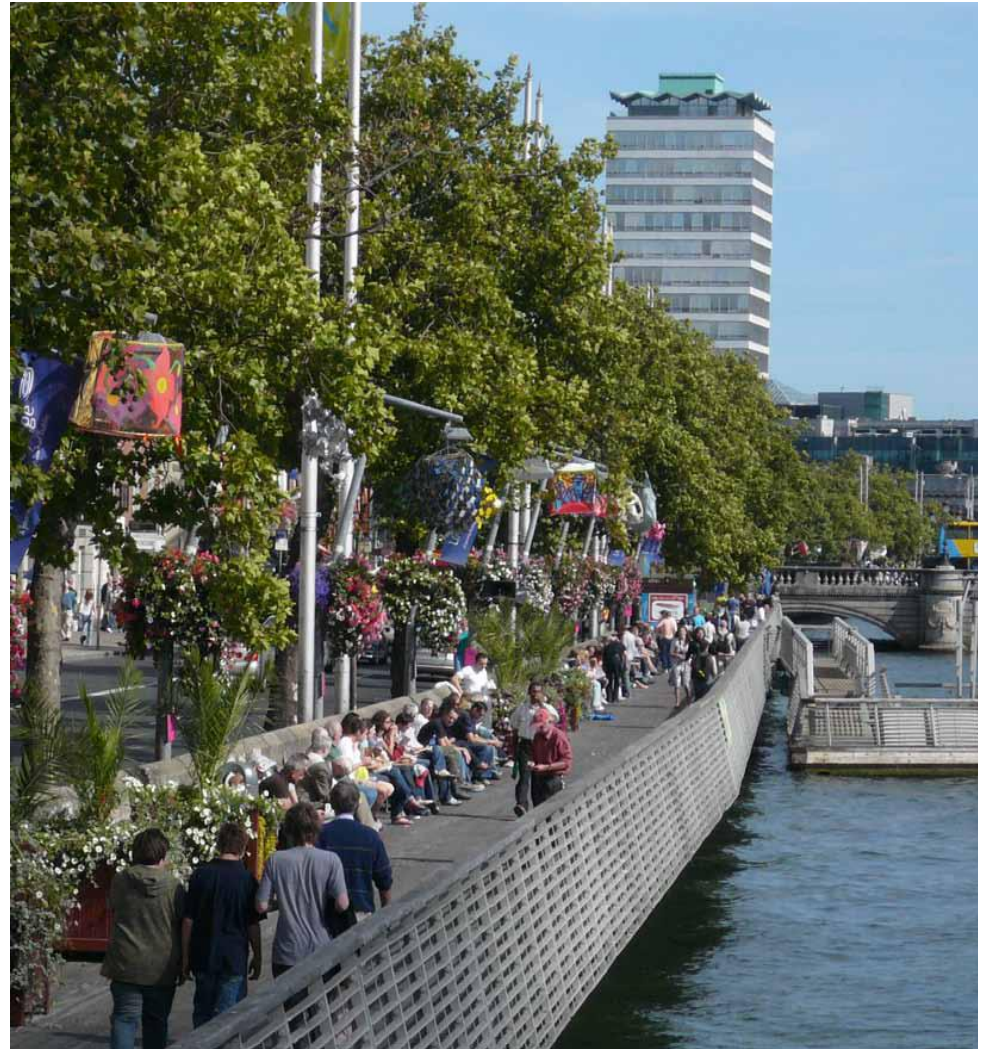

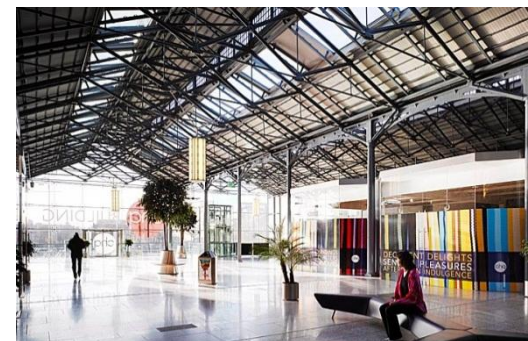





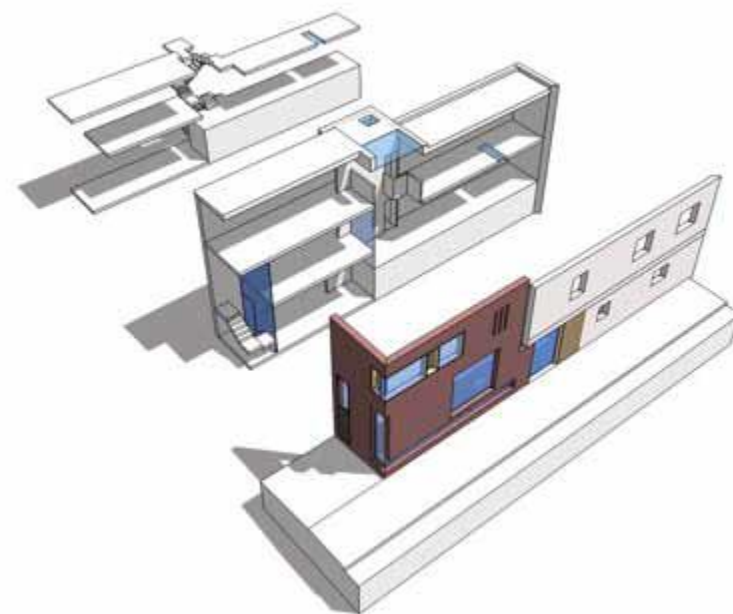





AMBITION



IMPLEMENTATION





www.architecturetours.ie

Architecture
Tours Ireland

Architecture
Tours Ireland

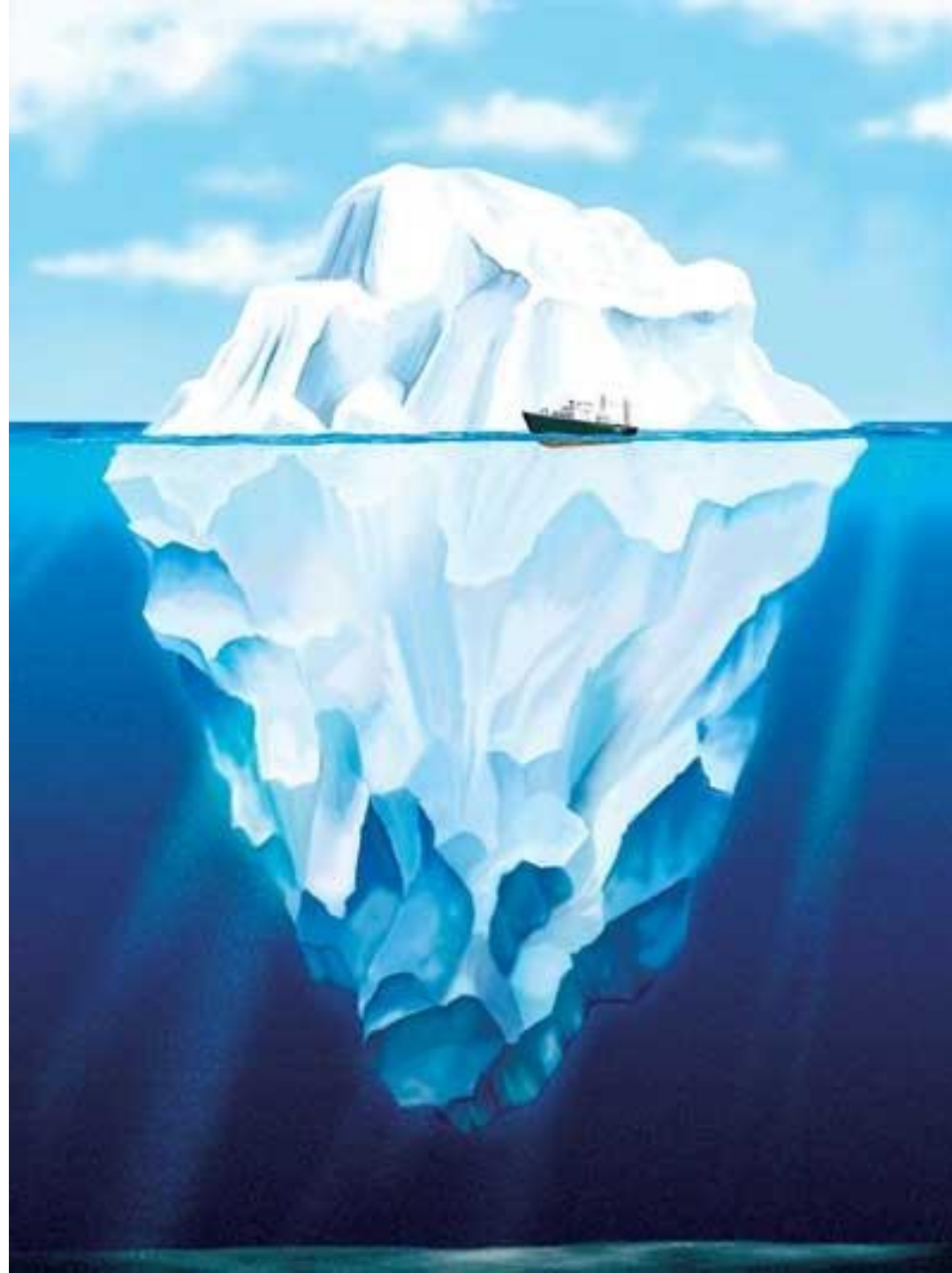

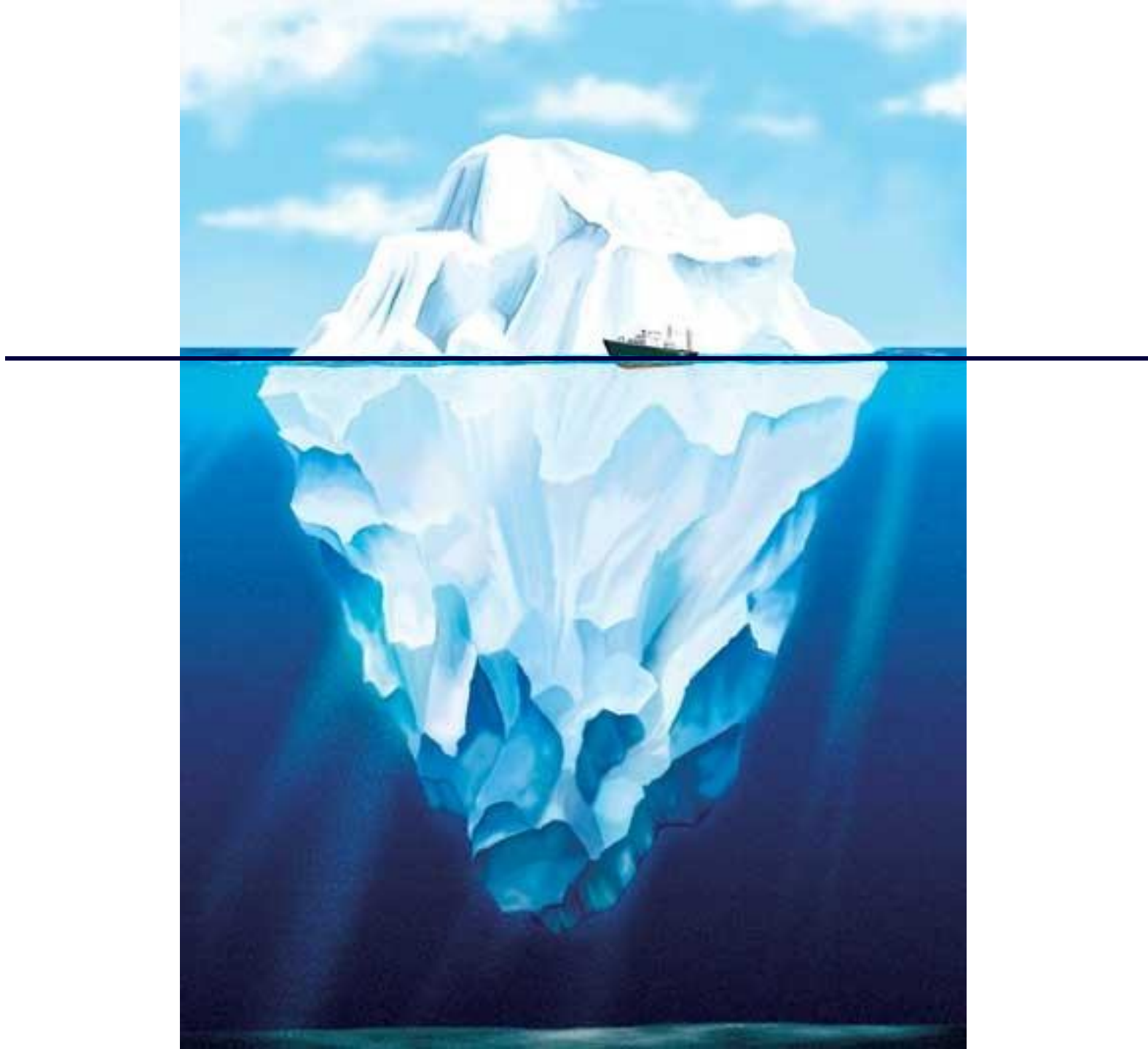

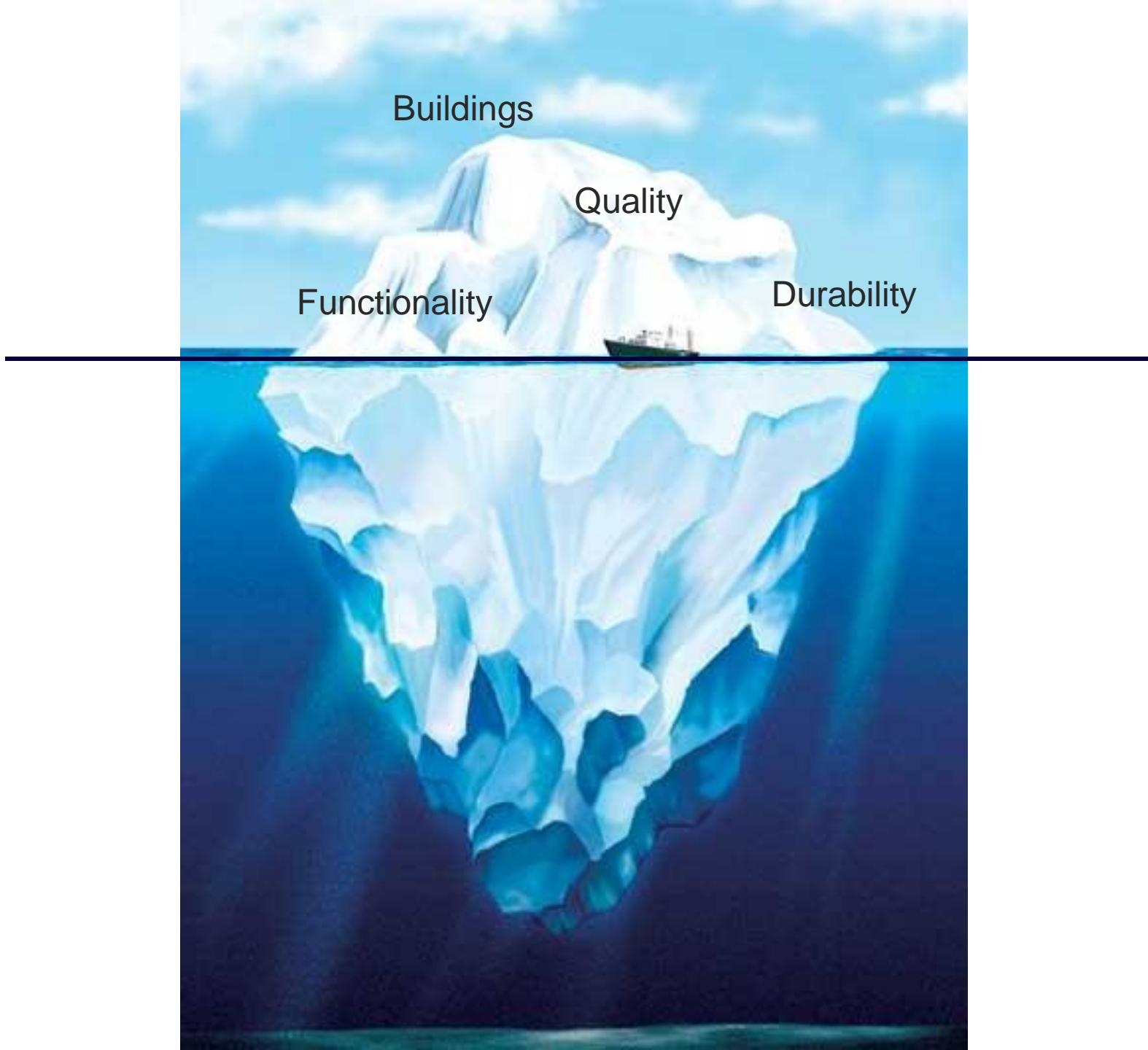

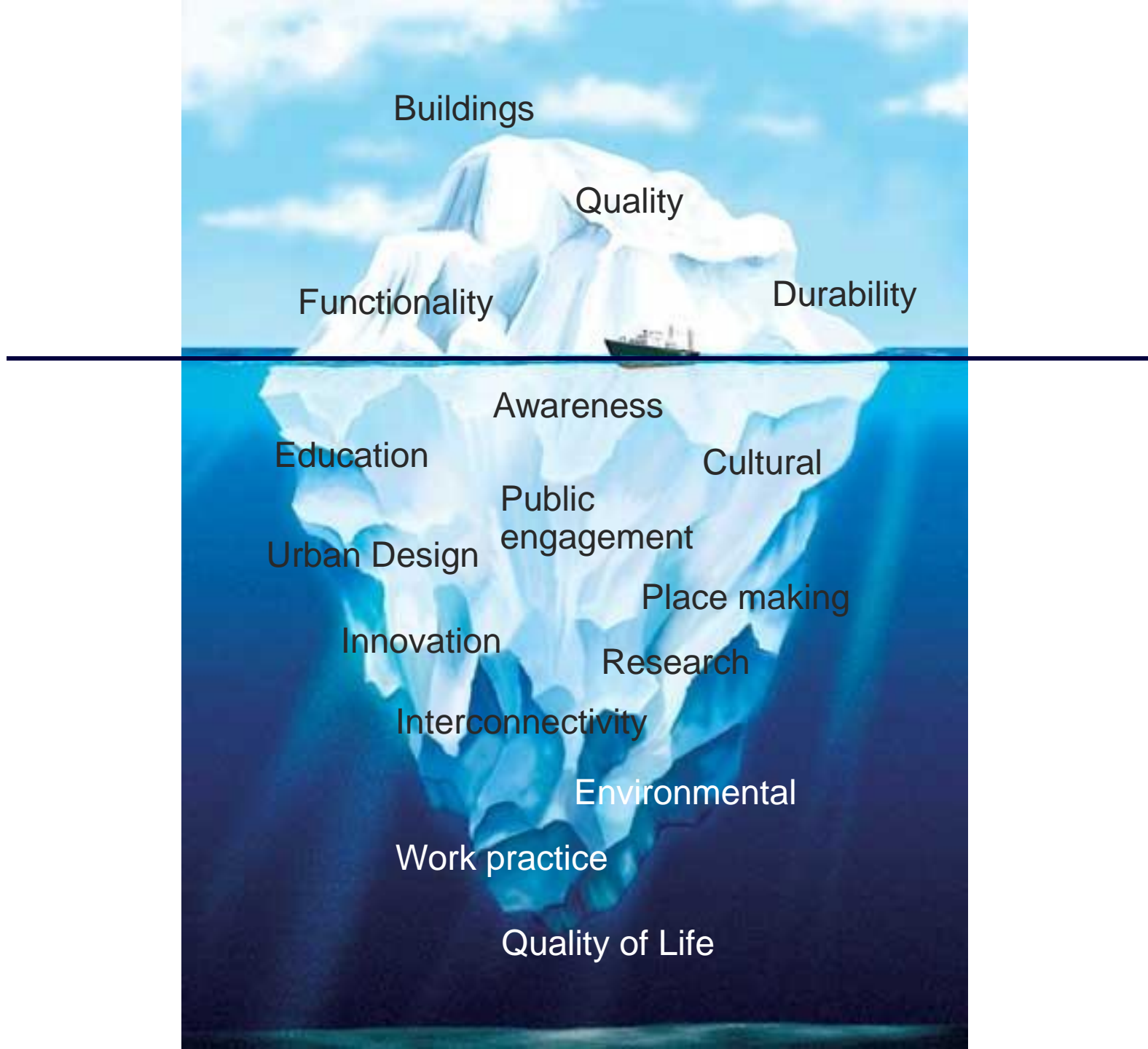



Direct Actions - **Hard**

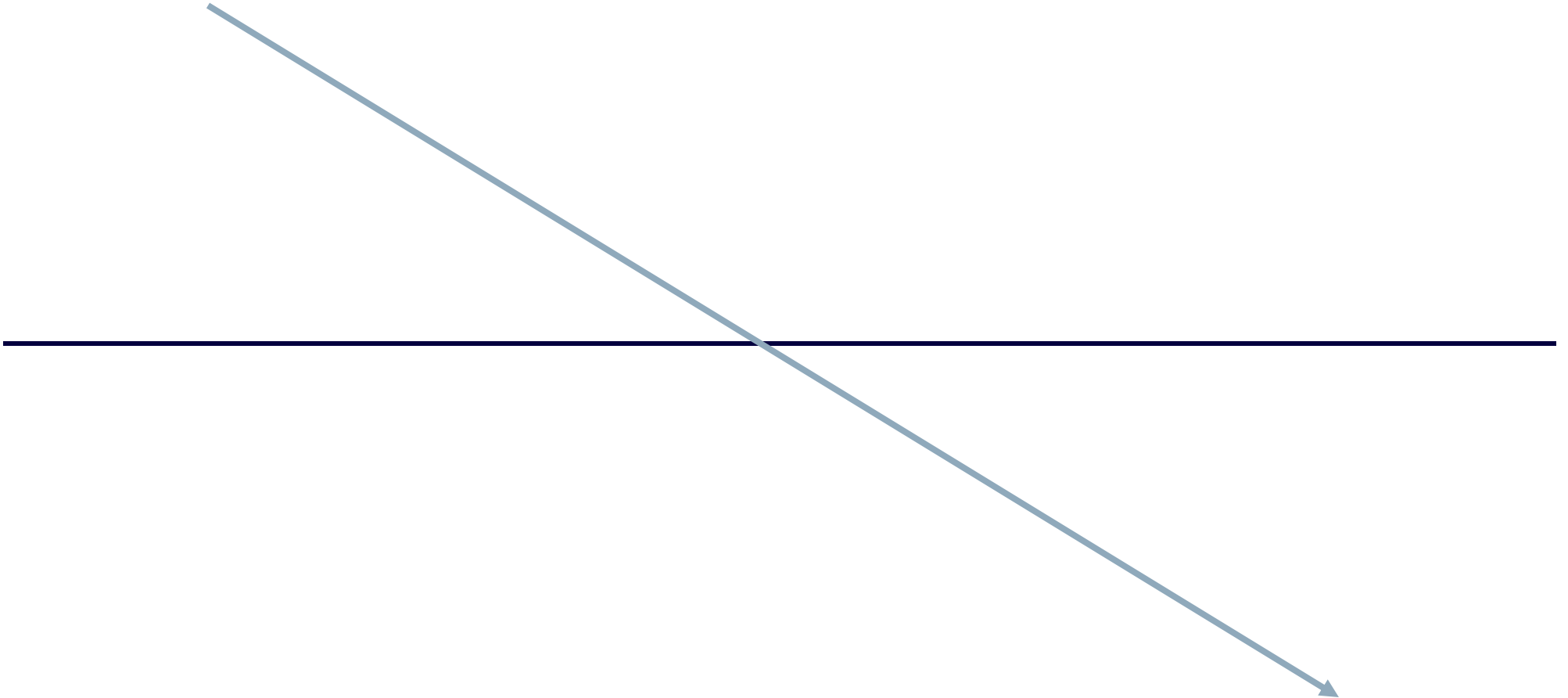

In Direct Actions - **Soft**

Direct Actions - **Hard**

45 Actions

Public and Private

Inter-Departmental

Multi- partner (Professional/Cultural Institutes/Agencies)

In Direct Actions - **Soft**



Direct Actions - **Hard**

45 Actions

Public and Private

Inter-Departmental

Multi- partner (Professional/Cultural Institutes/Agencies)

Multi Sectoral

Trans Disciplinary

Tangible / in-tangible Actions

Collaborative

In Direct Actions - **Soft**

Direct Actions - **Hard**

Research
Acts 1 – 5 (5)

In Direct Actions - **Soft**

Direct Actions - **Hard**

Research
Acts 1 – 5 (5)

Quality
Acts 6 -20 (15)

In Direct Actions - **Soft**

Direct Actions - **Hard**

Research
Acts 1 – 5 (5)

Quality
Acts 6 -20 (15)

Urban Design
Acts 21 – 27 (7)

In Direct Actions - **Soft**

Direct Actions - **Hard**

Research
Acts 1 – 5 (5)

Quality
Acts 6 -20 (15)

Urban Design
Acts 21 – 27 (7)

Awareness
Acts 28 – 45 (23)

In Direct Actions - **Soft**

Direct Actions - **Hard**

Research
Acts 1 – 5 (5)

In Direct Actions - **Soft**

Direct Actions - **Hard**

1, 2, 3, 4,

Research
Acts 1 – 5 (5)

5

In Direct Actions - **Soft**

Direct Actions - **Hard**

1, 2, 3, 4,

Research
Acts 1 – 5 (5)

5

UCD Built Environment Research paper Action 1(ii)
Colloquium & Recommendations 2011

RIAI Colloquium with Schools of Architecture – Report

ICOMOS International conference (Built Heritage Research)

In Direct Actions - **Soft**

Direct Actions - **Hard**

1, 2, 3, 4,

Research
Acts 1 – 5 (5)

5

UCD Built Environment Research paper Action 1(ii)
Colloquium & Recommendations 2011

RIAI Colloquium with Schools of Architecture – Report

ICOMOS International conference (Built Heritage
Research)

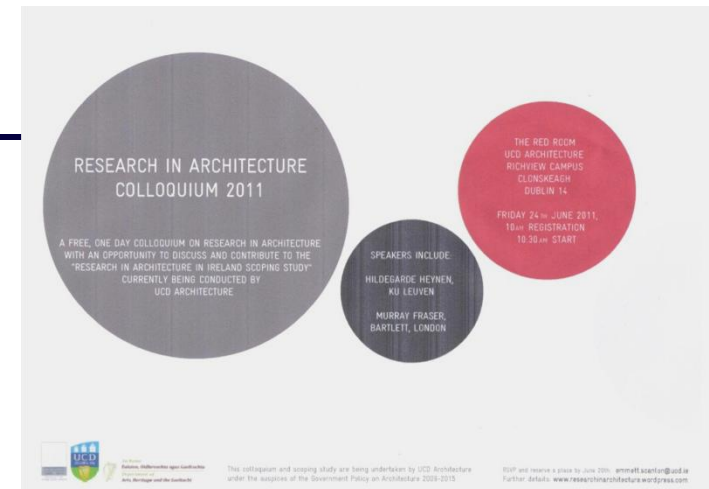

Irish Architectural Foundation: A space for learning
BT young scientist category

In Direct Actions - **Soft**

Direct Actions - **Hard**

6, 7, 8, 9, 10, 12,
14, 15, 16, 17, 18

Quality
Acts 6 -20 (15)

Quality in Urban Design & Architecture

Energy Efficiency in Traditional Buildings

Design Quality Indicators – *Quality Report*

State sponsored Conferences - Quality

Heritage Council – ECORYS report

Landscape Character Assessment (NLS)

11, 13, 19, 20

In Direct Actions - **Soft**

Direct Actions - **Hard**

Local Area Plans BPM – DAHG/DECLG

Action 21

High/large scale buildings in Urban Areas

Report: *Action 27(ii)*

21, 22, 23,
24, 25, 26,
27

Urban Design
Acts 21 – 27 (7)

In Direct Actions - **Soft**

Direct Actions - **Hard**

Local Area Plans BPM – DAHG/DECLG

Action 21

High/large scale buildings in Urban Areas

Report: *Action 27(ii)*

Retail Planning guidance – DAHG/DECLG

Action 21

“Re-use” best practice manual – DAHG *Action 23*

21, 22, 23,
24, 25, 26,
27

Urban Design
Acts 21 – 27 (7)



In Direct Actions - **Soft**

Direct Actions - **Hard**

Local Area Plans BPM – DAHG/DECLG

Action 21

High/large scale buildings in Urban Areas
Report: *Action 27(ii)*

Retail Planning guidance – DAHG/DECLG

Action 21

“Re-use” best practice manual – DAHG *Action 23*

21, 22, 23,
24, 25, 26,
27

Urban Design
Acts 21 – 27 (7)



Laois Urban Design/Heritage LAP Pilot

Kilkenny City Co Design review Pilot

University Limerick Urban Governance Pilot
programme

Dublin Civic trust – NIAH research/Conference
Publications – Re-drawing Dublin



In Direct Actions - **Soft**

Direct Actions - **Hard**

Engaging with Architecture Scheme – *DAHG/Arts Council*

RIAI Awards/ 3twenty10 competition/Publications

Internationalisation/Cultural branding on Architecture – EI and RIAI

Competitions

31, 32, 33,
36, 38, 43
44, 45

Awareness
Acts 28 – 45 (23)

28, 29, 30,
34, 35, 36,
37, 38, 39,
40, 41, 42,
44, 45

In Direct Actions - **Soft**

Direct Actions - **Hard**



Engaging with Architecture Scheme – *DAHG/Arts Council*

RIAI Awards/ 3twenty10 competition/Publications

Internationalisation/Cultural branding on Architecture – EI and RIAI

Competitions

31, 32, 33,
36, 38, 43
44, 45

Awareness
Acts 28 – 45 (23)

28, 29, 30,
34, 35, 36,
37, 38, 39,
40, 41, 42,
44, 45

In Direct Actions - **Soft**

Direct Actions - **Hard**



Engaging with Architecture Scheme – *DAHG/Arts Council*

RIAI Awards/ 3twenty10 competition/Publications

Internationalisation/Cultural branding on Architecture – EI and RIAI

Competitions

31, 32, 33,
36, 38, 43
44, 45

Awareness
Acts 28 – 45 (23)

**NATIONAL
ARCHITECTS
IN SCHOOLS
INITIATIVE**



Open House (IAF)/ Space for learning/ Core functions
IAF/Architectural Tours/Debate

World Design Capital bid 2014 - *DCC*

Exhibition and venue support – *RIAI/IAA/Darc space/Academic Institutions*

Irish Architectural Archive

28, 29, 30,
34, 35, 36,
37, 38, 39,
40, 41, 42,
44, 45

In Direct Actions - **Soft**

Direct Actions - **Hard**

1, 2, 3, 4,

Research
Acts 1 – 5 (5)

6, 7, 8, 9, 10, 12,
14, 15, 16, 17, 18

Quality
Acts 6 -20 (15)

21, 22, 23,
24, 25, 26,
27

Urban Design
Acts 21 – 27 (7)

31, 32, 33,
36, 38, 43
44, 45

Awareness
Acts 28 – 45 (23)

5

11, 13, 19, 20

28, 29, 30,
34, 35, 36,
37, 38, 39,
40, 41, 42,
44, 45

In Direct Actions - **Soft**

Direct Actions - **Hard**

Research
Acts 1 – 5 (5)

Quality
Acts 6 -20 (15)

Urban Design
Acts 21 – 27 (7)

Awareness
Acts 28 – 45 (23)

In Direct Actions - **Soft**

Direct Actions - **Hard**

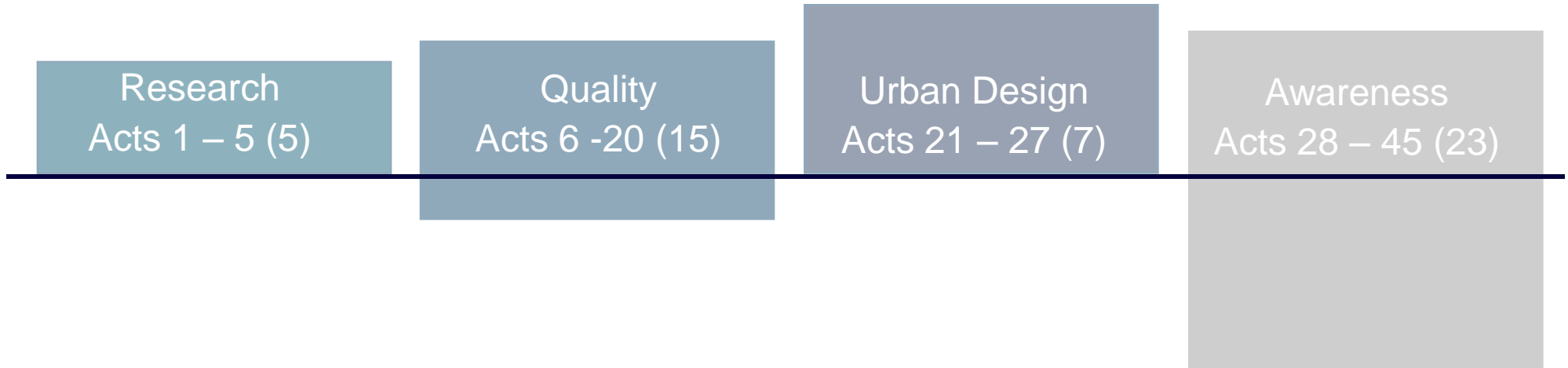

In Direct Actions - **Soft**

Direct Actions - **Hard**

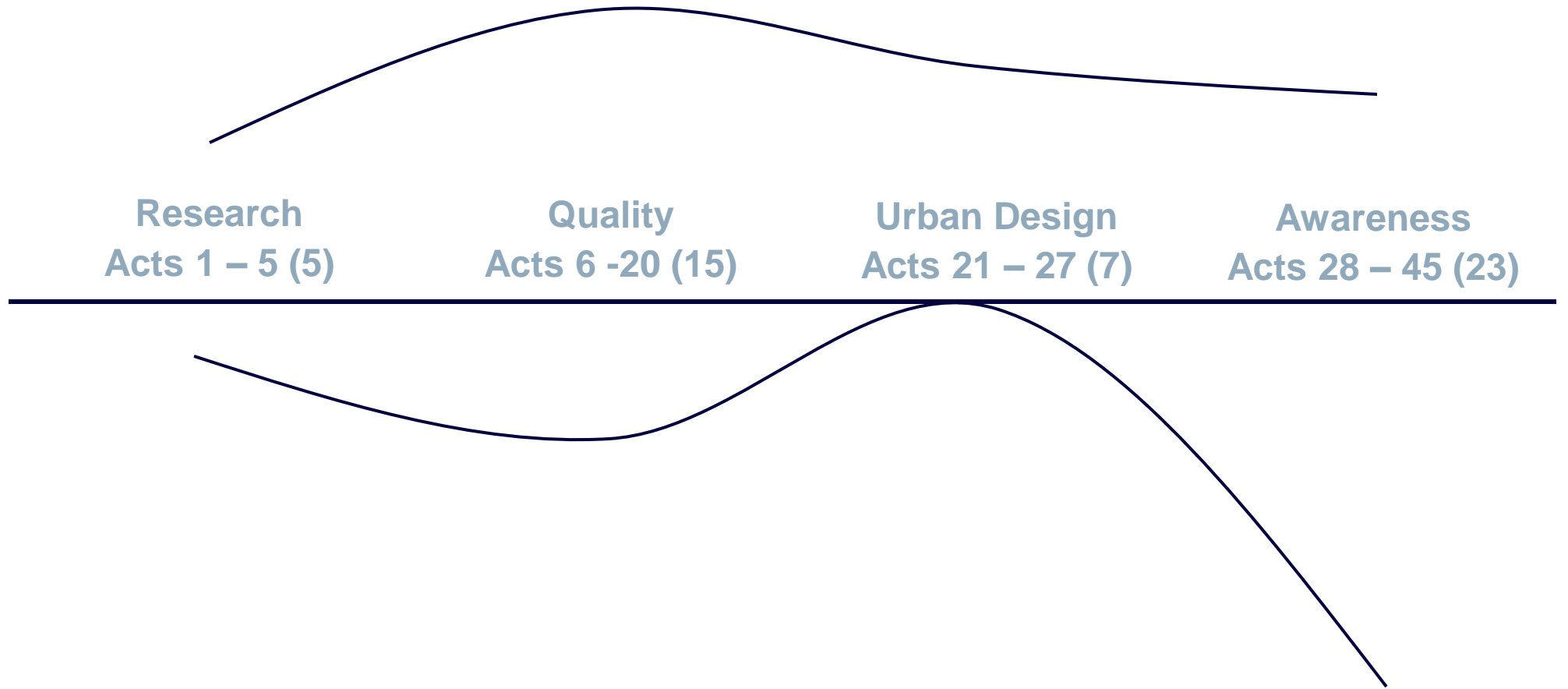

In Direct Actions - **Soft**

Direct Actions - **Hard**

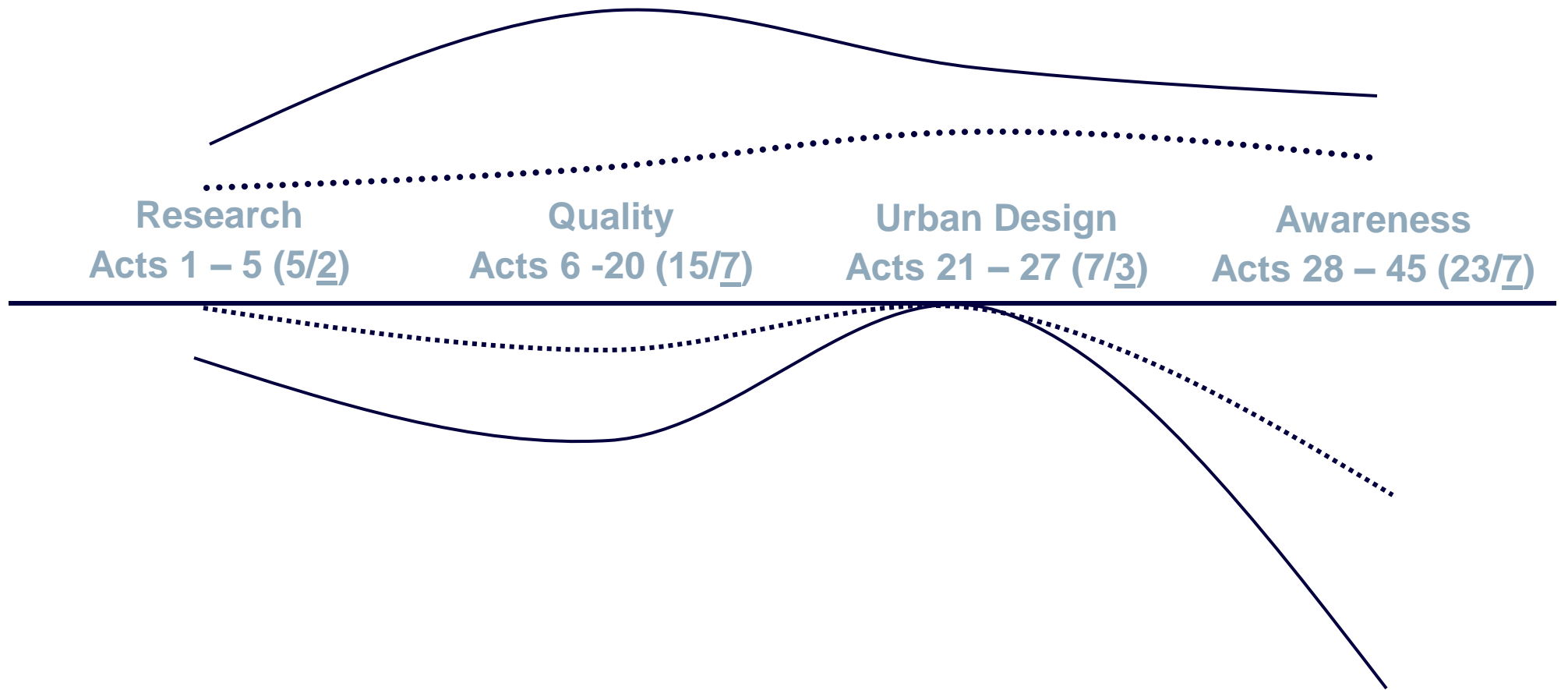

In Direct Actions - **Soft**

Direct Actions - **Hard**

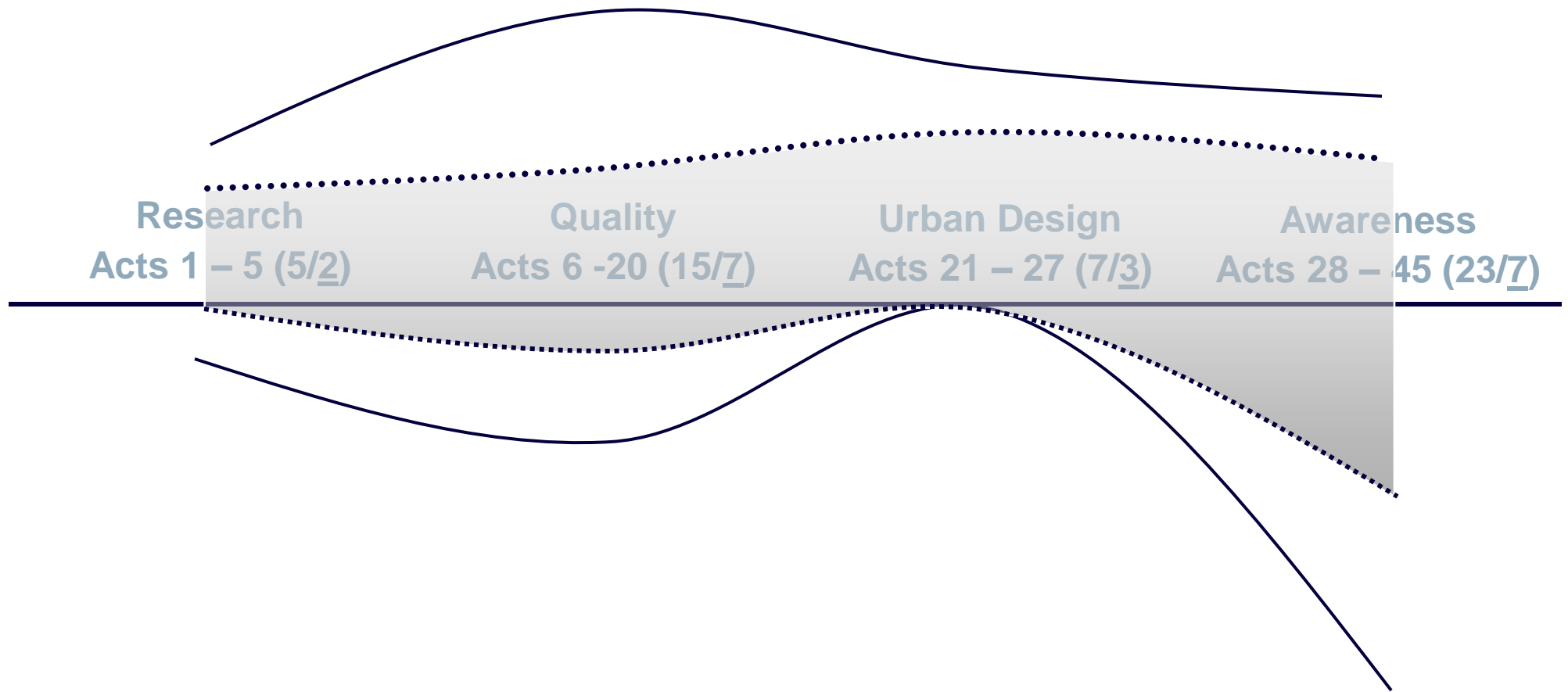

In Direct Actions - **Soft**

GPA Related Initiatives 2010-2014

- Reviewing the legislation for part (iv) Planning & Development Acts 2000-2011, as amended;
- New “Re-use” Best Practice Manual - Historic Places and Structures;
- DAHG/DECLG Retail planning Best practice Manual;
- Engagement with DECLG on LEADER funding – Heritage Initiatives;
- DAHG Engagement on Tourism related objectives/Places to visit etc;
- University of limerick pilot **urban governance** programme;
- RIAI / Kilkenny CAS peer review Pilot;
- Laois CoCo Pilot LAP on **Urban Design/Heritage** Issues;



PRIORITIES

IMPLEMENTATION



Macro Priorities recently launched DAHRRGA

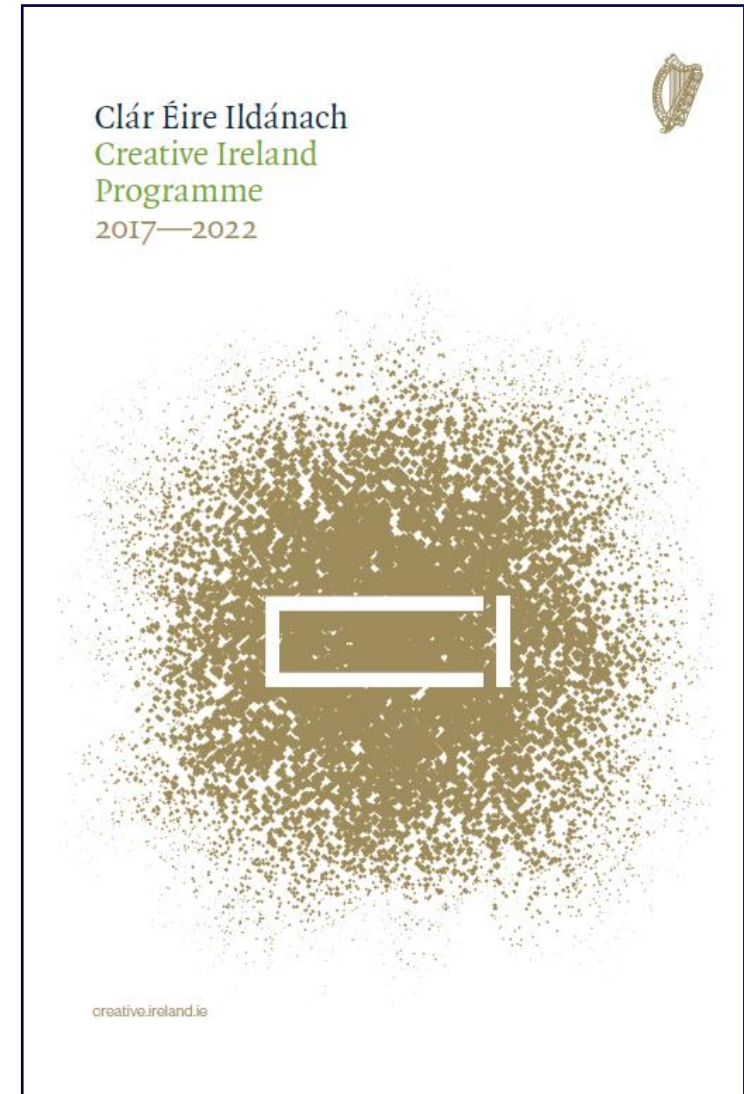
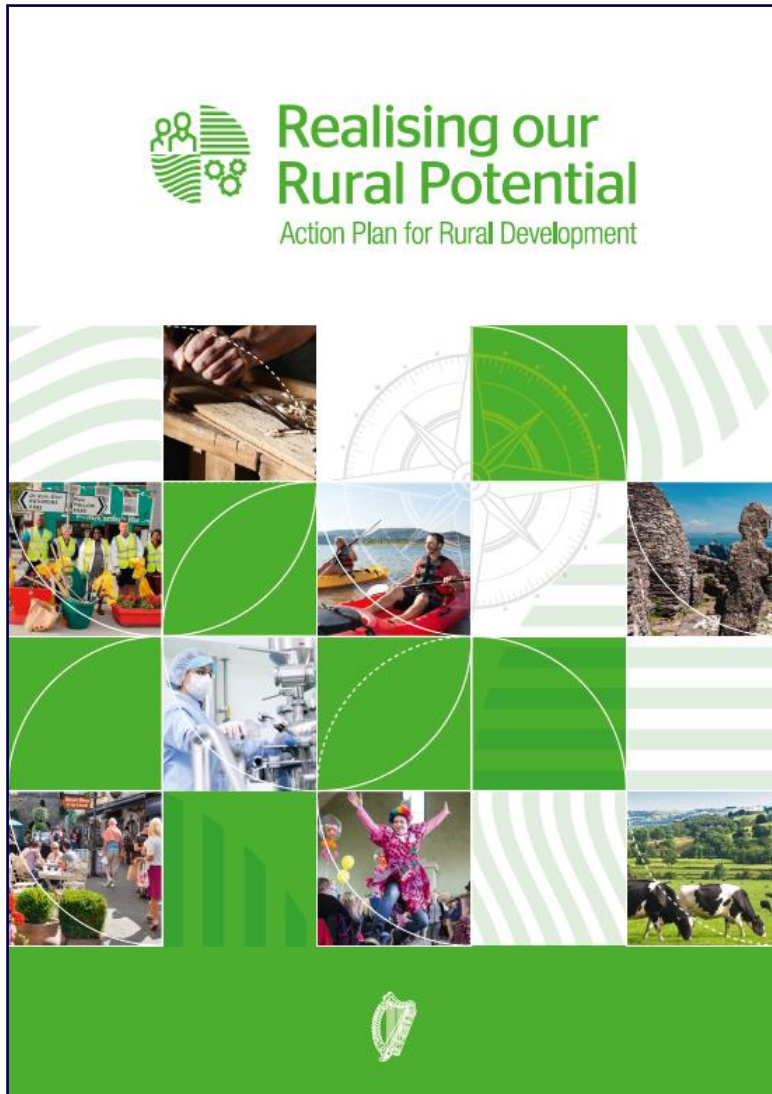

Heritage & Architectural Policy objectives in 2017 include:

- Develop and conclude fiscal strategies: Incentives for Built Heritage with Department of Finance/DPER (Capital Stimulus, continued tax incentives and heritage led regeneration or reuse) incl. ERDF Funding/Horizon 2020;
- Monitor and profile all expenditure relating to the Built Heritage Capital/Current Programme of the Department to invest in heritage renewal (Built Heritage Jobs Leverage Scheme, Historic Towns Initiative, Living City Initiative and Home improvement scheme 2013);
- Completion/review of the Government Policy on Architecture 2009-2015 priority actions and direct grant in aid for 2016;
- Use and co-ordinate funding available (LEADER (RDP)/FI/DPER) to invest in heritage conservation and tourism renewal;
- Continued engagement on Referrals/Strategic Infrastructure Projects;

GPA Related Initiatives 2012-2015

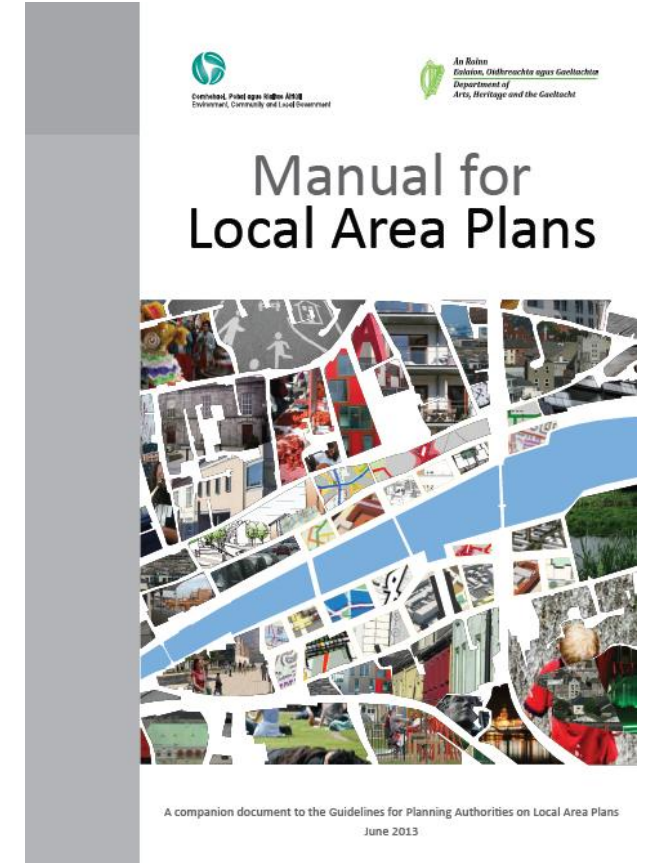
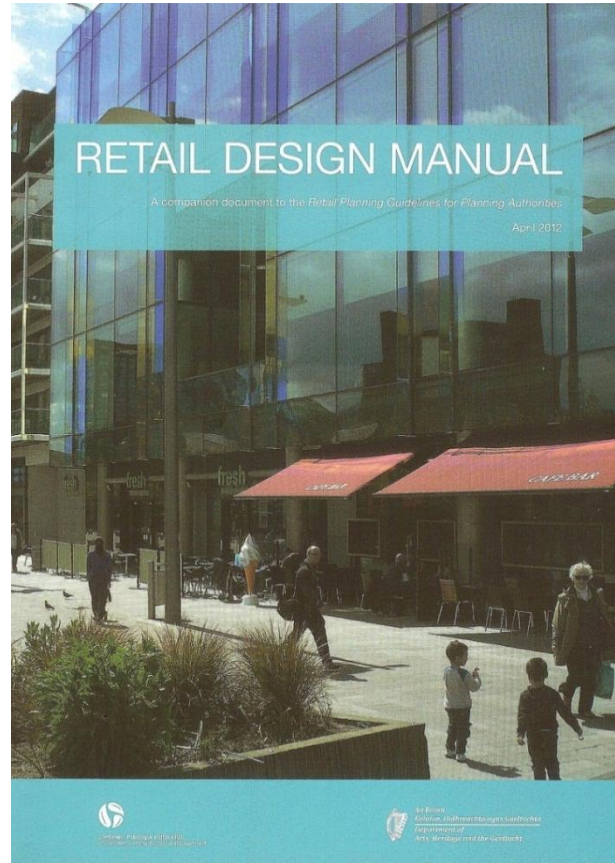
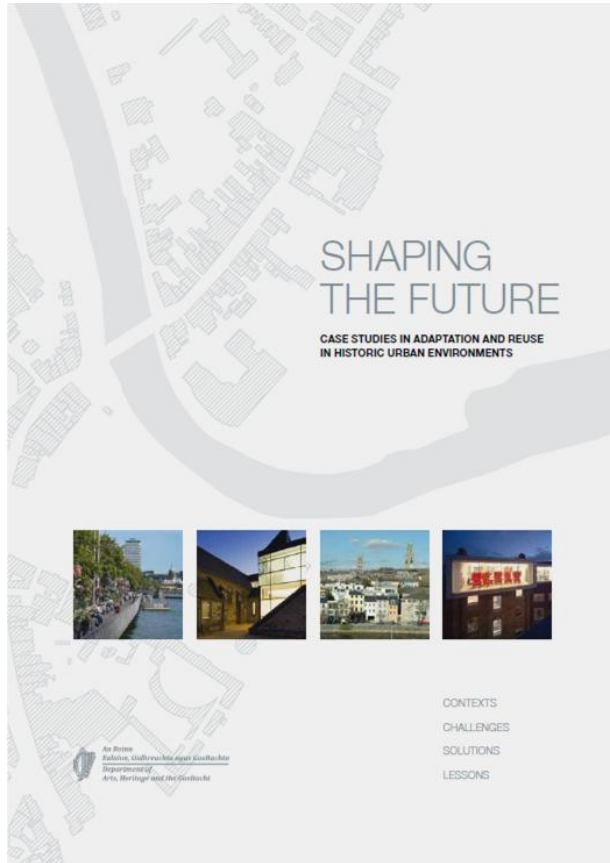



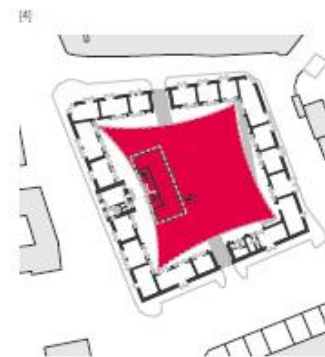





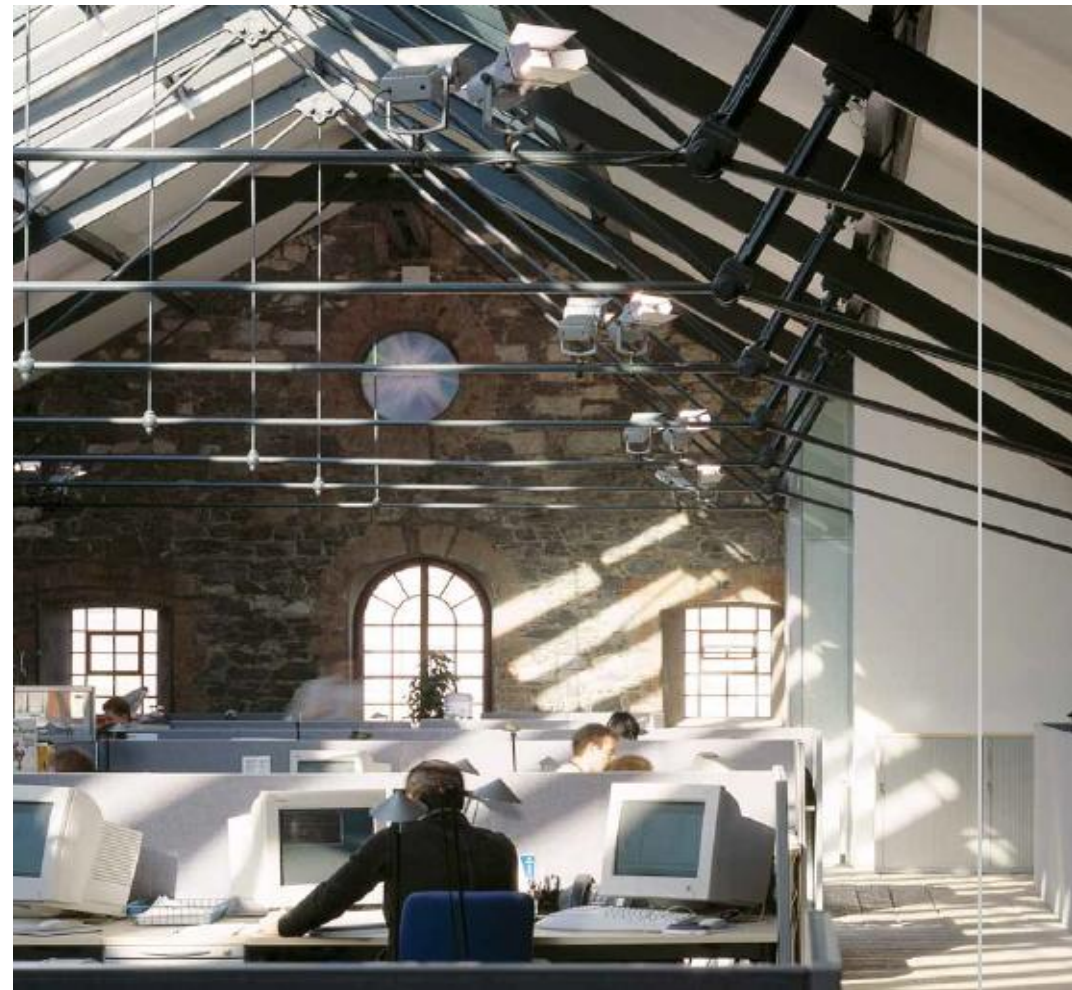





series of large rooflights provide an uninterrupted view of the sky and flood the space with natural light giving the occupant the perception that he/she is outside

o conserve the urban fabric and the character of the street, the volumetric integrity of the existing house was to be retained

he new extension is 'stepped out' to be rear of the long, narrow form of the existing plan

rchitect's drawing showing the 'layering' of the existing and new elements working together to make a new architecture





precious state of preservation.

Context

CORK HISTORIC CENTRE ACTION PLAN

PROJECT TEAM:
CORK CORPORATION AND
URBAN INITIATIVES

CLIENT:
CORK CITY COUNCIL

DATE:
1994

CONTEXT

The historic centre of Cork city contains one of the richest concentrations of built heritage in Ireland. Effectively an island development in the Laa, the history of the medieval city can still be read in its urban plan, built form and in its architectural character. It has retained many of its historic townhouses, some fine municipal architecture and many of the warehouses which supported the city's economy in the eighteenth and nineteenth centuries. Also, with few exceptions, it has retained its medium-rise skyline and its fine-grain urban structure.

CHALLENGE

In the early 'nineties, the historic centre encapsulated many of the problems facing cities everywhere – both in Ireland and abroad: increased tendencies for retailing, commercial and other development to relocate out of the centre, leaving dereliction and blight behind. Similarly, with people moving to housing in the suburbs, the indigenous communities in the centre were in decline, in some cases leaving only the poor and disadvantaged behind.

These conditions set the city council the challenge of defining a new vision for the historic centre, and the task of reviving its social and economic vitality, reversing the decline which had left much of its historic fabric in a precarious state of preservation.



CASE STUDIES IN ADAPTATION AND REUSE IN HISTORIC URBAN ENVIRONMENTS

National Landscape Strategy 2015 - 2025

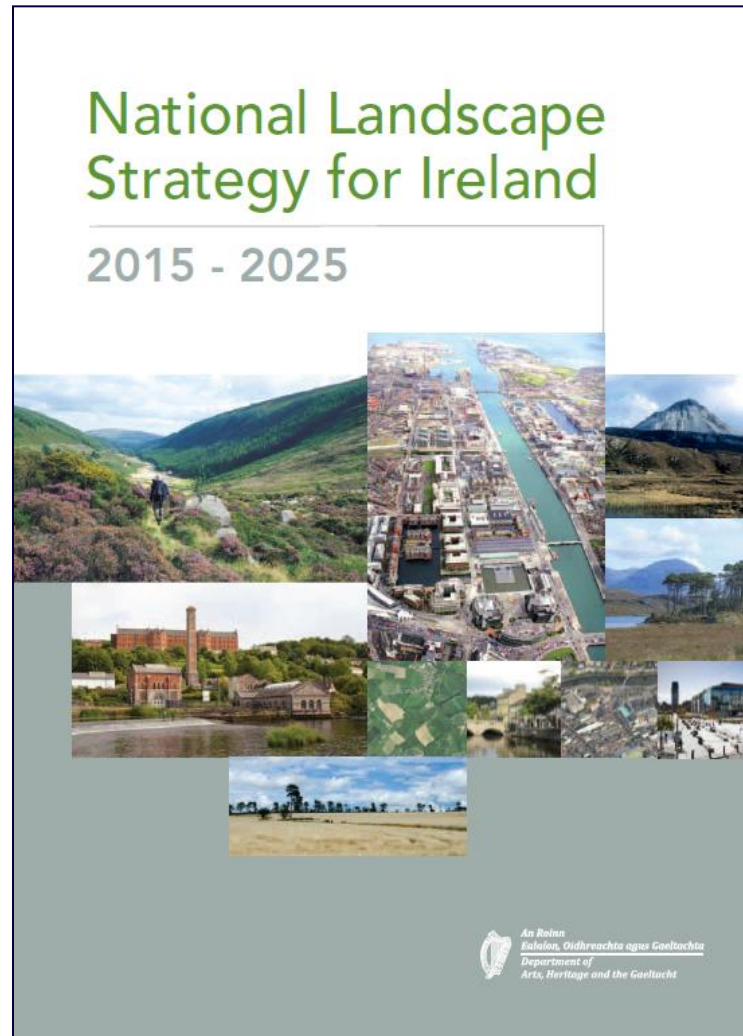

Built Heritage Capital Investment Programme

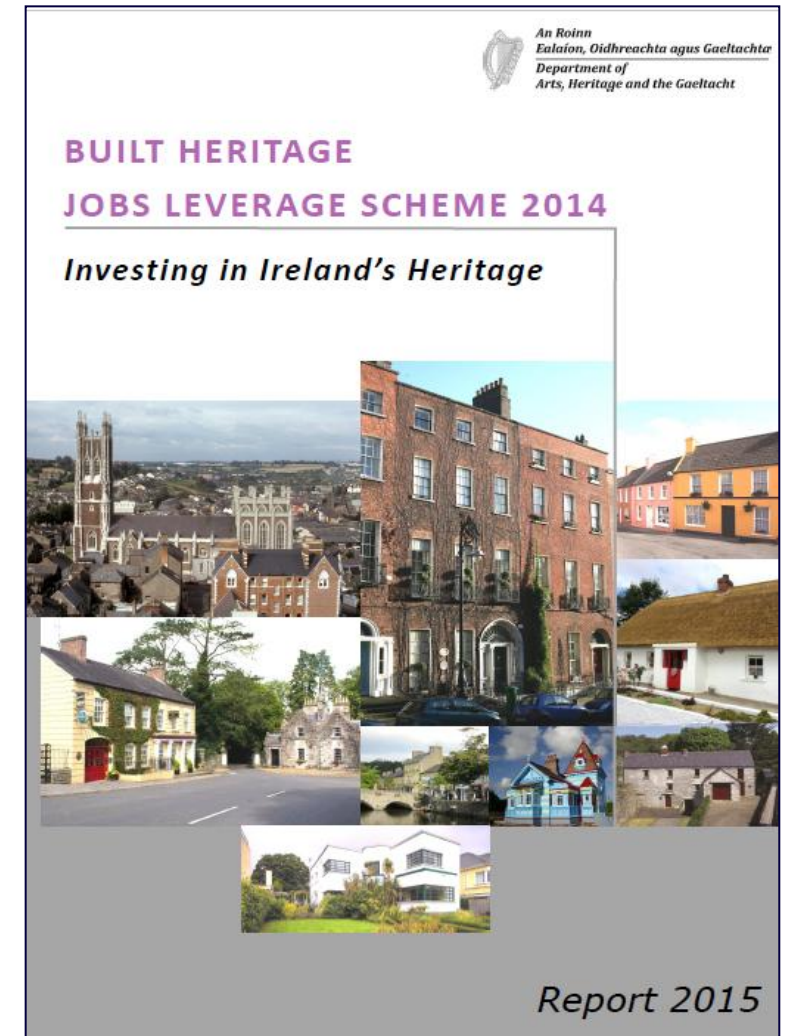

Department of Finance - Living City Initiative Launch 2015 (Pilot 2013)



Living City Initiative*

A new Pilot project for Urban Regeneration

Information Note

Department of Finance

February 2013

*This Initiative will be subject to EU State Aid approval

Historic Towns Initiative (HTI) Pilot 2013-2014

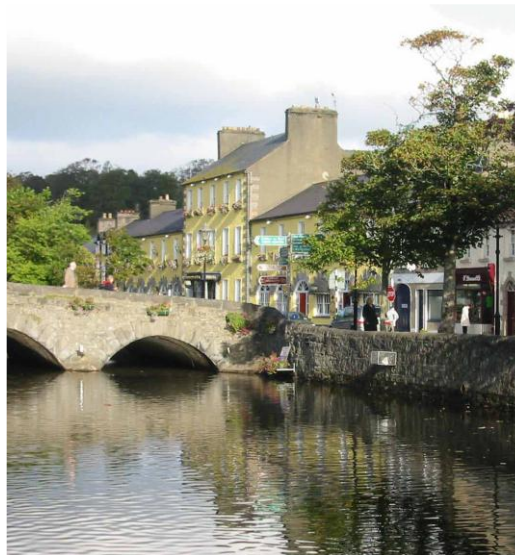

HISTORIC TOWNS INITIATIVE

Framework for the Pilot Phase

Listowel ■ Westport ■ Youghal
2013 – 2014



Historic Towns Initiative (HTI): Pilot Framework/Toolkit

- EU-funded Interreg project INHERIT '*A Guide to Successful Urban Regeneration*' (2007);
- Heritage-led regeneration projects across Europe, including Belfast. The INHERIT report listed some of the risks of focusing on cultural tourism development as including:
 - (i) *The creation of a mono-functional space where the character and heritage of a place becomes compromised and every business and space is given over to tourism activities;*
 - (ii) *Construction of new and unsympathetic visitor infrastructure;*
 - (iii) *Loss of culture and unique identity.*

Historic Towns Initiative (HTI): Pilot Framework/Toolkit

- 1. Spatial planning:**
 - Strategic objectives in Development Plan/LAP's;
 - Urban Design Framework approach;
 - Quality in Design/application to Public Realm;
- 2. Fiscal incentives:**
 - Specific incentives to be examined;
 - Create the right environment for growth;
- 3. Urban Governance:**
 - Implementation and control mechanisms;
 - Quality assurance;
 - Local external bodies/community groups;
- 4. Funding:**
 - Alternative mechanisms for financial leverage;
- 5. Construction employment:**
 - Heritage led-regeneration approach to “re-use”;
- 6. Post review on Pilot:**
 - Evidence based approach or “Learning by doing”.



- Strategic urban design approach to the Built Environment based on architectural and qualitative ***urban design*** place-making principles;
- Education and awareness of our ***existing*** Built Environment and the role of architecture;
- Delivery of an ***integrated*** approach to the Built Environment with quality as core criteria;
- Joint collaborative approach – measurable tangible outcomes in the Built Environment – ***Trans disciplinary and Multi-Sectoral***;

- Strategic urban design approach to the Built Environment based on architectural and qualitative ***urban design*** place-making principles;

QUALITY OF LIFE AND PLACE-MAKING

- Education and awareness of our ***existing*** Built Environment and the role of architecture;

KNOWLEDGE & CULTURE

- Delivery of an ***integrated*** approach to the Built Environment with quality as core criteria;

WELL MADE

- Joint collaborative approach – measurable tangible outcomes in the Built Environment – ***Trans disciplinary and Multi-Sectoral***;

INNOVATION & PROCESS



An Roinn Ealaíon, Oidhreachta,
Gnóthaí Réigiúnacha, Tuaithe agus Gaeltachta
Department of Arts, Heritage,
Regional, Rural and Gaeltacht Affairs

[Gaeilge](#) [Sitemap](#) [Contact](#)



Search



About

Arts

Heritage

Gaeltacht

News Centre



Minister Humphreys launches Town and Village Renewal Scheme for Rural Ireland

Latest

[News](#) [Speeches](#) [Tweets](#) [Publications](#)

29/08/2016

Minister Donohoe signs Memorandum of Understanding on Cultural Cooperation and Exchange with China

29/08/2016

New Dublin public art piece will highlight role of women in 1916 – Minister Humphreys

26/08/2016

Minister Ring announces over €750,000 capital investment in Killarney National Park for 2016

[See all news](#)

Featured



North/South Co-operation

North/South Co-operation continues to be a key priority for the Department.

19
2016

Ireland 2016

This year we will mark the centenary of the 1916 Easter Rising, a key moment on



Culture 2025 / Éire Ildánach

The draft of Éire Ildánach / Culture 2025 may be downloaded [here](#)

We use cookies to ensure that we give you the best experience on our website. If you continue to use this site we will assume that you are happy with it.

[OK](#)

www.ahrrga.gov.ie

Built Heritage and Architectural Policy



Government Policy on Architecture 2009–2015
Towards a Sustainable Future: Delivering Quality within the Built Environment

Images supplied courtesy of RIAI practices and members, Local Authorities, conversations about Architecture 2008
GPA 2009–2015, Architecture Ireland, Shaping the Future 2012, (RIAI and IAF).